

B E E C H C R A F T  
DUKE B60  
I L L U S T R A T E D P A R T S C A T A L O G

LIST OF PAGES & TABLE OF CONTENTS  
FOR  
CHAPTER 39-00-00 ELEC PANELS,PARTS,INST.

CHAP/SUB- SECT & UNIT	PAGE NO.	EFFECTIVE DATE	TABLE OF CONTENTS
39-00-00	1	04/19/84.	LIST OF PAGES & TABLE OF CONTENTS . . . . .
39-10-01	1	03/20/81.	FLOATING INSTRUMENT PANEL . . . . .
39-10-01	2	03/20/81	
39-10-01	3	01/08/82	
39-10-01	4	03/20/81	
39-10-01	5	04/19/84	
39-10-01	6	03/20/81	
39-10-01	7	01/08/82	
39-10-20	1	03/20/81.	INSTRUMENT PANEL PLUMBING /SINGLE/. . . . .
39-10-20	2	03/20/81	
39-10-20	3	04/16/82	
39-10-20	4	01/08/82	
39-10-20	5	04/19/84	
39-10-20	6	03/20/81	
39-10-20	7	01/08/82	
39-10-30	1	03/20/81.	INSTRUMENT PANEL PLUMBING /DUAL/. . . . .
39-10-30	2	03/20/81	
39-10-30	3	04/16/82	
39-10-30	4	01/08/82	
39-10-30	5	01/08/82	
39-10-30	6	04/16/82	
39-10-30	7	04/19/84	
39-10-40	1	03/20/81.	INSTRUMENT SUBPANEL ASSEMBLY. . . . .
39-10-40	2	03/20/81	
39-10-40	3	03/20/81	
39-10-40	4	01/08/82	
39-10-40	5	01/08/82	
39-10-40	6	03/20/81	
39-10-40	7	03/20/81	
39-10-40	8	03/20/81	
39-10-40	9	03/20/81	
39-10-40	10	03/20/81	
39-10-40	11	03/20/81	
39-10-40	12	03/20/81	
39-10-40	13	01/08/82	
39-10-40	14	03/20/81	
39-10-40	15	01/08/82	
39-15-01	1	03/20/81.	INDEPENDENT INSTRUMENTS /CABIN/ . . . . .
39-15-01	2	03/20/81	
39-15-01	3	01/08/82	



BEECHCRAFT  
DUKE B60  
ILLUSTRATED PARTS CATALOG

39-10-01  
FLOATING INSTRUMENT PANEL

BEECHCRAFT  
DUKE B60  
ILLUSTRATED PARTS CATALOG

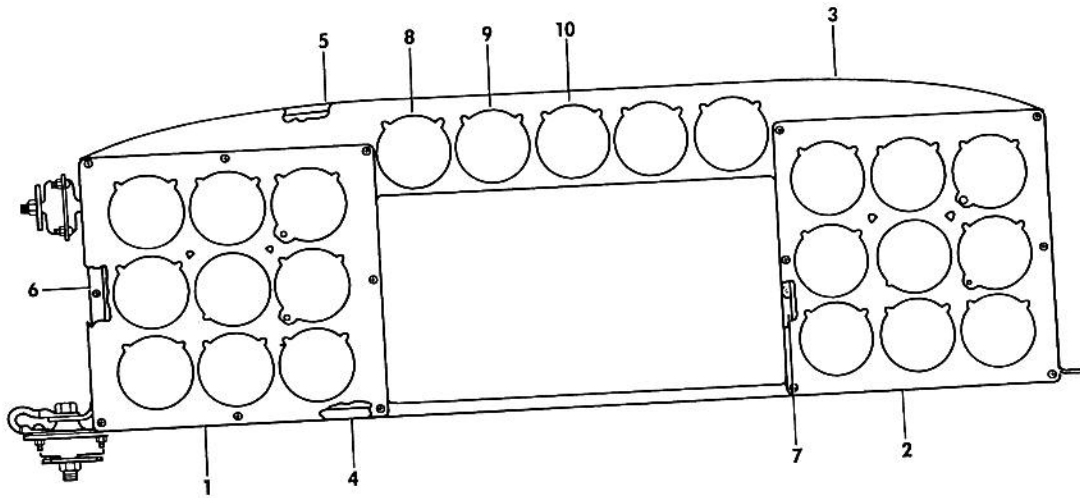
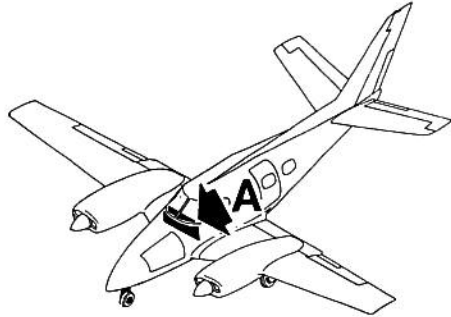

VIEW **A**

B60-391-2

B E E C H C R A F T  
DUKE B60  
I L L U S T R A T E D P A R T S C A T A L O G

GAMA/ATA CODE & INDEX NO.	PART NO.	DESCRIPTION							UNITS PER ASSY	USABLE ON CODE
		1	2	3	4	5	6	7		
10-01	60-324000-605	PANEL ASSY, INSTRUMENT/COMPLETE WITH PLUMBING/ /FOR INSTRUMENT PANEL PLUMBING SEE CHAPTER 39-10-20 FOR SINGLE INSTRUMENTS & CHAPTER 39-10-30 FOR DUAL INSTRUMENTS/ /ATTACHING PARTS/							1	
	AN6-15A	BOLT, LOWER SHOCK MOUNT. . . . .							2	
	AN801303	WASHER. . . . .							2	
	130909N25	NUT, LOWER SHOCK MOUNT . . . . .							2	
	AN4-14A	BOLT, UPPER SHOCK MOUNT. . . . .							2	
	AN801302	WASHER, UPPER SHOCK MOUNT. . . . .							2	
	130909N32	NUT, UPPER SHOCK MOUNT . . . . .							2	
	60-324000-607	. PANEL ASSY, INSTRUMENT . . . . .							1	
- 1	60-324000-611	. . . PANEL, LH BLANK. . . . .							1	2
	R 58-530253-9	. . . PANEL, WOODGRAIN/50TH ANNIVERSARY/ . . . . .							1	23
	60-324000-91	. . . PANEL, LH BLANK. . . . .							1	3
- 2	60-324000-613	. . . PANEL, RH BLANK. . . . .							1	2
	R 58-530253-10	. . . PANEL, WOODGRAIN/50TH ANNIVERSARY/ . . . . .							1	23
	60-324000-93	. . . PANEL, RH BLANK. . . . .							1	3
	60-324000-609	. PANEL ASSY. . . . .							1	14
	60-324000-121	. PANEL ASSY. . . . .							1	15
- 3	60-324000-65	. . . PANEL . . . . .							1	14
	60-324000-125	. . . PANEL . . . . .							1	15
- 4	60-324000-71	. . . ZEE, SECTION . . . . .							1	
- 5	60-324000-73	. . . CHANNEL, UPPER . . . . .							1	14
- 6	60-324000-129	. . . CHANNEL, UPPER . . . . .							1	15
	60-324000-69	. . . BRACKET, LH INSTRUMENT PANEL . . . . .							1	
	60-324000-70	. . . BRACKET, RH INSTRUMENT PANEL . . . . .							1	
- 7	60-324000-67	. . . CHANNEL, INBD INSTRUMENT /LH AND RH/ . . . . .							2	
	60-340155-1	. . . TAB, RADIO PANEL SUPPORT . . . . .							2	
	60-324000-89	. . . CLIP. . . . .							2	14
	60-324000-131	. . . CLIP. . . . .							2	15
	130290-2	. . . NUT, CLIP. . . . .							2	
	MS21073L08	. . . NUT PLATE . . . . .							2	
	MS21061L08	. . . NUTPLATE. . . . .							4	
	MS21059L08	. . . NUT PLATE . . . . .							8	
	130909N33	. . . NUT PLATE . . . . .							4	
- 8	50-380011-27	. GAGE, MANIFOLD PRESSURE/POST LIT/. . . . .							1	16
	50-380011-41	. GAGE, MANIFOLD PRESSURE/POST LIT/. . . . .							1	17
	96-384056-5	. GAGE, MANIFOLD PRESSURE/WEDGE LIT/. . . . .							1	18
	96-384056-13	. GAGE, MANIFOLD PRESSURE/WEDGE LIT/. . . . .							1	17
- 9	96-380014-5	. TACHOMETER, SINGLE/POST LIT/ . . . . .							1	16
	96-380014-17	. TACHOMETER, SINGLE/POST LIT/ . . . . .							1	17
	96-384057-5	. TACHOMETER, SINGLE/WEDGE LIT/. . . . .							1	18
	96-384057-17	. TACHOMETER, SINGLE/WEDGE LIT/. . . . .							1	17
	50-380010-27	. TACHOMETER, DUAL WITH SYNCH/POST LIT/. . . . .							1	18
	50-380010-43	. TACHOMETER, DUAL WITH SYNCH/POST LIT/. . . . .							1	17
	96-384059-5	. TACHOMETER, DUAL WITH SYNCH/WEDGE LIT/. . . . .							1	18
	96-384059-17	. TACHOMETER, DUAL WITH SYNCH/WEDGE LIT/. . . . .							1	17
- 10	60-384070-1	. INDICATOR, FUEL FLOW/POST LIT/ . . . . .							1	4
	60-384082-1	. INDICATOR, FUEL FLOW/POST LIT/ . . . . .							1	6
	60-384086-1	. INDICATOR, FUEL FLOW/POST LIT/ . . . . .							1	22
	60-384070-3	. INDICATOR, FUEL FLOW/WEDGE LIT/. . . . .							1	5
	60-384082-3	. INDICATOR, FUEL FLOW/WEDGE LIT/. . . . .							1	6
	60-384086-3	. INDICATOR, FUEL FLOW/WEDGE LIT/. . . . .							1	22

BEECHCRAFT  
DUKE B60  
ILLUSTRATED PARTS CATALOG

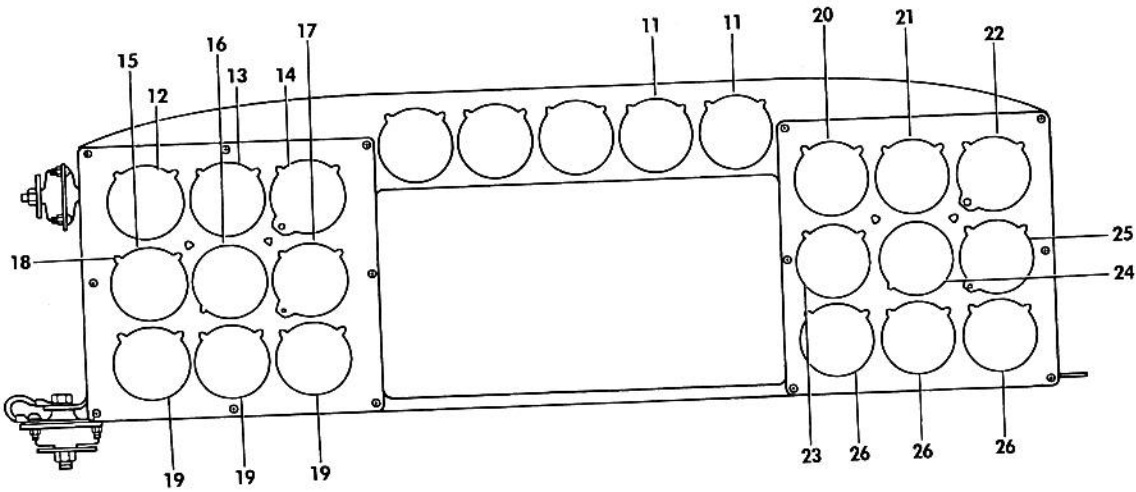
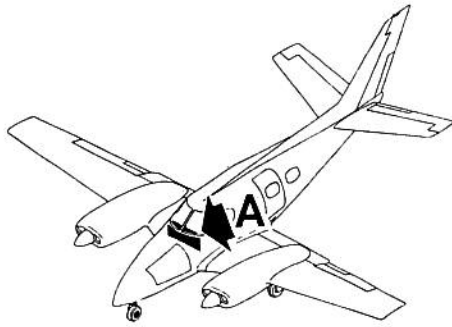

VIEW A

B60-391-3

B E E C H C R A F T  
DUKE B60  
I L L U S T R A T E D P A R T S C A T A L O G

SUB-SECT UNIT & ITEM NO.	PART NO.	DESCRIPTION	1 2 3 4 5 6 7							UNITS PER ASSY	USABLE ON CODE
			1	2	3	4	5	6	7		
10-01 - 11	50-389080-3	. GAGE,ENGINE/POST LIT/ . . . . .								2	7
	60-384080-1	. GAGE,ENGINE/POST LIT/ . . . . .								2	8
	60-384072-3	. GAGE,ENGINE/WEDGE LIT/ . . . . .								2	9
	60-384079-1	. GAGE,ENGINE/WEDGE LIT/ . . . . .								2	10
- 12	60-384024-5	. INDICATOR,AIR SPEED/KNOTS ONLY,POST LIT/ . . . . .								1	
	100-384051-5	. INDICATOR,AIR SPEED/DUAL SCALE,POST LIT/ . . . . .								1	11
	102-380001-25	. INDICATOR,AIR SPEED/DUAL SCALE,POST LIT/ . . . . .								1	12
	58-380037-13	. INDICATOR,AIR SPEED/KNOTS ONLY,WEDGE LIT/ . . . . .								1	1
	58-380010-13	. INDICATOR,AIR SPEED/DUAL SCALE,WEDGE LIT/ . . . . .								1	13
	102-380002-25	. INDICATOR,AIR SPEED/DUAL SCALE,WEDGE LIT/ . . . . .								1	12
- 13	50-384203	. GYRO HORIZON/POST LIT/ALTERNATE 50-384203/ . . . . .								1	
	50-384202	. GYRO HORIZON/POST LIT/ALTERNATE 50-384202/ . . . . .								1	
	58-380013-1	. GYRO HORIZON/WEDGE LIT/ALTERNATE 58-380013-3/ . . . . .								1	1
	58-380013-3	. GYRO HORIZON/WEDGE LIT/ALTERNATE 58-380013-1/ . . . . .								1	1
- 14	58-380069-5	. ALTIMETER/POST LIT/SUPERSEDES 99-384039/ . . . . .								1	
	58-380069-7	. ALTIMETER/WEDGE LIT/SUPERSEDES 99-384039-1/ . . . . .								1	1
- 15	1680	. TURN COORDINATOR/POST LIT/TC100 24V/ . . . . .								1	19
		/ORDER 58-380085-3/									
	58-380085-3	. TURN COORDINATOR/POST LIT/ . . . . .								1	21
	58-380020-3	. TURN COORDINATOR/WEDGE LIT/ORDER 58-380094-3/ . . . . .								1	20
	58-380094-3	. TURN COORDINATOR/WEDGE LIT/ . . . . .								1	21
- 16	50-384204	. GYRO,DIR/POST LIT/ALTERNATE 50-384205/ . . . . .								1	
	50-384205	. GYRO,DIR/POST LIT/ALTERNATE 50-384204/ . . . . .								1	
	58-380014-1	. GYRO,DIR/WEDGE LIT/ALTERNATE 58-380014-3/ . . . . .								1	1
	58-380014-3	. GYRO,DIR/WEDGE LIT/ALTERNATE 58-380014-1/ . . . . .								1	1
- 17	50-384073	. INDICATOR,VERTICAL SPEED/POST LIT/ . . . . .								1	
	58-380018-1	. INDICATOR,VERTICAL SPEED/WEDGE LIT/ . . . . .								1	1
- 18	A897082-327	. LIGHT ASSY,POST . . . . .								AR	
- 19	50-324103-1	. BEZEL . . . . .								3	
- 20	60-384024-5	. INDICATOR,AIR SPEED/KNOTS ONLY,POST LIT/ . . . . .								1	
	100-384051-5	. INDICATOR,AIR SPEED/DUAL SCALE,POST LIT/ . . . . .								1	11
	102-380001-25	. INDICATOR,AIR SPEED/DUAL SCALE,POST LIT/ . . . . .								1	12
	58-380037-13	. INDICATOR,AIR SPEED/KNOTS ONLY,WEDGE LIT/ . . . . .								1	1
	58-380010-13	. INDICATOR,AIR SPEED/DUAL SCALE,WEDGE LIT/ . . . . .								1	13
	102-380002-25	. INDICATOR,AIR SPEED/DUAL SCALE,WEDGE LIT/ . . . . .								1	12
- 21	R 50-384202	. GYRO HORIZON/POST LIT/ . . . . .								1	
	R 50-384202-3	. GYRO HORIZON/POST LIT/SPARES FOR 50-384202/ . . . . .								1	
	R 50-384203	. GYRO HORIZON/POST LIT/ . . . . .								1	
	R 50-384203-3	. GYRO HORIZON/POST LIT/SPARES FOR 50-384203/ . . . . .								1	
	58-380013-1	. GYRO HORIZON/WEDGE LIT/ALTERNATE 58-380013-3/ . . . . .								1	1
	58-380013-3	. GYRO HORIZON/WEDGE LIT/ALTERNATE 58-380013-1/ . . . . .								1	1
- 22	58-380069-5	. ALTIMETER/POST LIT/SUPERSEDES 99-384039/ . . . . .								1	
	58-380069-7	. ALTIMETER/WEDGE LIT/SUPERSEDES 99-384039-1/ . . . . .								1	1
- 23	101-380030-1	. INDICATOR,TURN & SLIP/POST LIT/ . . . . .								1	1
		/SUPERSEDES 50-380023-1 INDICATOR/									
- 24	60-384075-1	. INDICATOR,TURN & SLIP/WEDGE LIT/ . . . . .								1	1
	50-384204	. GYRO,DIR/POST LIT/ALTERNATE 50-384205/ . . . . .								1	
	50-384205	. GYRO,DIR/POST LIT/ALTERNATE 50-384204/ . . . . .								1	
	58-380014-1	. GYRO,DIR/WEDGE LIT/ALTERNATE 58-380014-3/ . . . . .								1	1
	58-380014-3	. GYRO,DIR/WEDGE LIT/ALTERNATE 58-380014-1/ . . . . .								1	1
- 25	50-384073	. INDICATOR,VERTICAL SPEED/POST LIT/ . . . . .								1	
	58-380018-1	. INDICATOR,VERTICAL SPEED/WEDGE LIT/ . . . . .								1	1
- 26	50-324103-1	. BEZEL . . . . .								3	
	58-380022-11	. LIGHT TRAY ASSY,WEDGE . . . . .								AR	1
		/ATTACHING PARTS/									
	MS35198-11	. SCREW . . . . .								2	
	102-340063	PLACARD,IDENT/RADIO CALL/ . . . . .								1	
	R 36-530135-1	PLAQUE,50TH ANNIVERSARY . . . . .								1	23
	R 60-340151-9	PANEL,BLANK RADIO . . . . .								1	

BEECHCRAFT  
DUKE B60  
ILLUSTRATED PARTS CATALOG

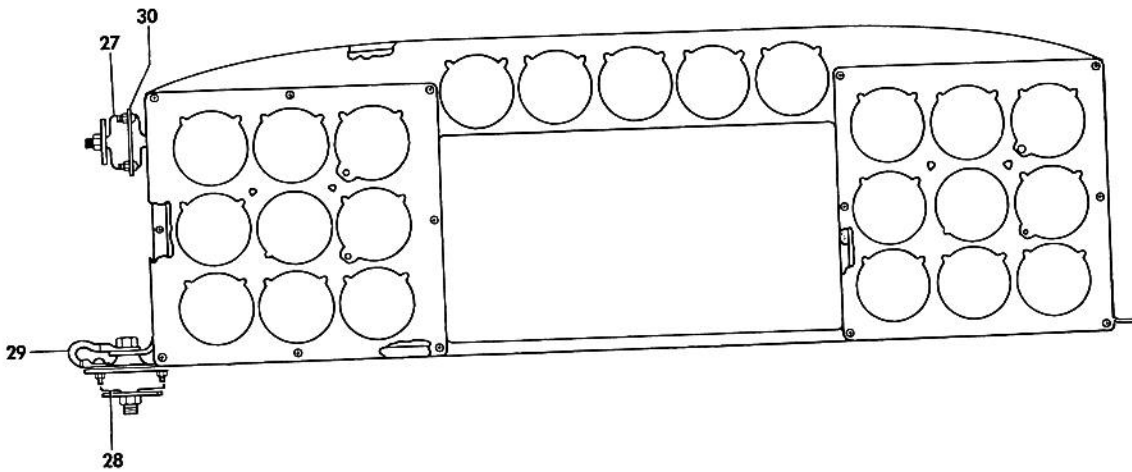
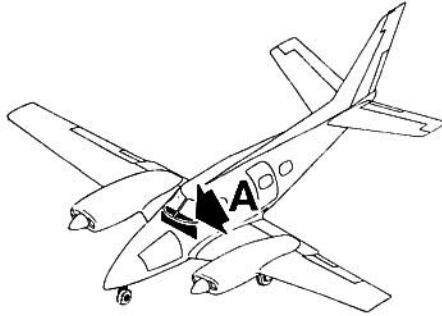

VIEW A

B60-391-4



B E E C H C R A F T  
DUKE B60  
I L L U S T R A T E D P A R T S C A T A L O G

GAMA/ATA CODE & INDEX NO.	PART NO.	DESCRIPTION							UNITS PER ASSY	USABLE ON CODE
		1	2	3	4	5	6	7		
10-01 - 27	156PL13								2	
- 28	206PL30								NP	
	206PL45								2	
	MS35207-261								2	
	AN960D10L								2	
	MS21042L3								2	
- 29	MS25083-2BE5								1	
- 30	60-324023-13								1	
	60-324023-14								1	

C O D E S O F E F F E C T I V I T Y

1	P-263 AND AFTER	2	P-247 THRU P-321
3	P-322 AND AFTER	4	P-247 THRU P-426 P-430, P-434 THRU P-465
5	P-263 THRU P-426 P-430, P-434 THRU P-465	6	P-427 THRU P-429 P-431 THRU P-433 P-466 THRU P-534
7	P-247 THRU P-444	8	P-445 AND AFTER
9	P-263 THRU P-440 AND P-444	10	P-441 THRU P-443 P-445 AND AFTER
11	P-247 THRU P-450	12	P-451 AND AFTER
13	P-263 THRU P-450	14	P-247 THRU P-492
15	P-493 AND AFTER	16	P-247 THRU P-522
17	P-523 AND AFTER	18	P-263 THRU P-522
19	P-247 THRU P-539	20	P-263 THRU P-539
21	P-540 AND AFTER	22	P-535 AND AFTER
23	P-581 THRU P-604		



BEECHCRAFT  
DUKE B60  
ILLUSTRATED PARTS CATALOG

39-10-20  
INSTRUMENT PANEL PLUMBING /SINGLE/

BEECHCRAFT  
DUKE B60  
ILLUSTRATED PARTS CATALOG

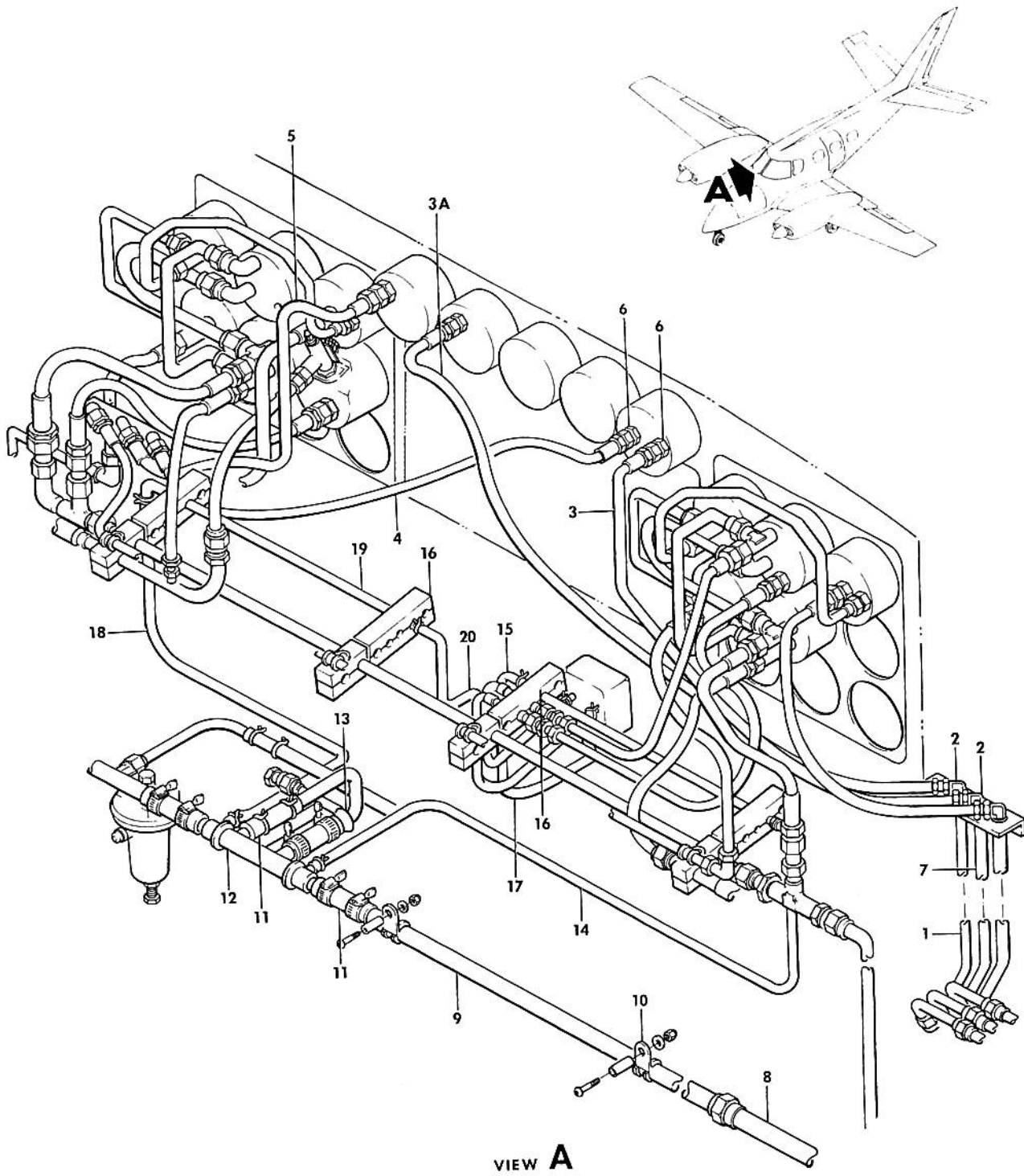

VIEW A

B60-393-2

FIGURE 10-20-INSTRUMENT PANEL PLUMBING  
/SHEET 1 OF 3 SHEETS/

B E E C H C R A F T  
DUKE 860  
I L L U S T R A T E D P A R T S C A T A L O G

GAMA/ATA CODE & INDEX NO.	PART NO.	DESCRIPTION							UNITS PER ASSY	USABLE ON CODE
		1	2	3	4	5	6	7		
10-20	60-320000-305	PLUMBING INSTL, SINGLE INSTRUMENT PANEL. . . . .							NP	
- 1	60-320000-19	• TUBE ASSY, MANIFOLD PRESSURE . . . . .							1	
	60-320000-20	• TUBE ASSY, MANIFOLD PRESSURE . . . . .							1	
- 2	AN833-40	• ELBOW, BULKHEAD. . . . .							7	
- 3	AN6270-4-23 1/2	• HOSE, LH MANIFOLD PRESSURE . . . . .							1	
- 3A	AN6270-4-33	• HOSE, LH OIL PRESSURE. . . . .							1	
- 4	AN6270-4-33	• HOSE, RH MANIFOLD PRESSURE . . . . .							1	
- 5	AN6270-4-21 1/2	• HOSE, RH OIL PRESSURE. . . . .							1	
- 6	AN816-40	• NIPPLE, MANIFOLD PRESSURE GAGE . . . . .							4	
- 7	60-320000-17	• TUBE ASSY, OIL PRESSURE LH . . . . .							1	
	60-320000-18	• TUBE ASSY, OIL PRESSURE RH . . . . .							1	
- 8	60-320000-33	• TUBE ASSY, INSTRUMENT PRESSURE . . . . .							1	
	60-320000-35	• TUBE ASSY, INSTRUMENT PRESSURE . . . . .							1	
- 9	60-320000-37	• TUBE ASSY, INSTRUMENT PRESSURE . . . . .							1	
- 10	MS21919DG10	• CLAMP, LH PRESSURE TUBE. . . . .							2	
		/ATTACHING PARTS/								
	AN520-8R22	• SCREW . . . . .							2	
	AN960-8	• WASHER. . . . .							2	
	130909N28	• NUT . . . . .							2	
	100696D-ZC027	• SPACER. . . . .							2	
- 11	106200H10-10	• HOSE, PRESSURE MANIFOLD. . . . .							4	
	AN737TW34	• CLAMP, PRESSURE MANIFOLD HOSE. . . . .							8	
	1H24-6	• MANIFOLD, PRESSURE . . . . .							1	
- 13	60-320000-25	• PLUG, MANIFOLD . . . . .							1	
- 14	60-320000-57	• HOSE, LH INSTRUMENT PRESSURE . . . . .							1	
	130292A6	• CLAMP, LH & RH INSTRUMENT PRESSURE GAGE TUBE . . . . .							2	
- 15	60-320000-139	• TUBE, LH INSTRUMENT PRESSURE GAGE. . . . .							1	
- 16	60-324078-1	• CLAMP, INSTRUMENT PLUMBING TUBE. . . . .							4	
		/SELL IN MATCHED SETS/								
	R 60-324078-7	• CLAMP, INSTRUMENT PLUMBING TUBE. . . . .							4	
		/SELL IN MATCHED SETS/								
		/ATTACHING PARTS/								
	R MS24693-275	• SCREW . . . . .							8	
	AN960-10	• WASHER. . . . .							8	
	130909N29	• NUT . . . . .							8	
- 17	60-320000-129	• HOSE, LH INSTRUMENT PRESSURE GAGE. . . . .							1	
	130292A8	• CLAMP . . . . .							8	
- 18	60-320000-55	• TUBE, RH INSTRUMENT PRESSURE GAGE. . . . .							1	
	130292A6	• CLAMP, RH INSTRUMENT PRESSURE GAGE TUBE. . . . .							2	
- 19	60-320000-141	• TUBE, RH INSTRUMENT PRESSURE GAGE. . . . .							1	
- 20	60-320000-129	• TUBE, RH INSTRUMENT PRESSURE GAGE. . . . .							1	

BEECHCRAFT  
DUKE B60  
ILLUSTRATED PARTS CATALOG

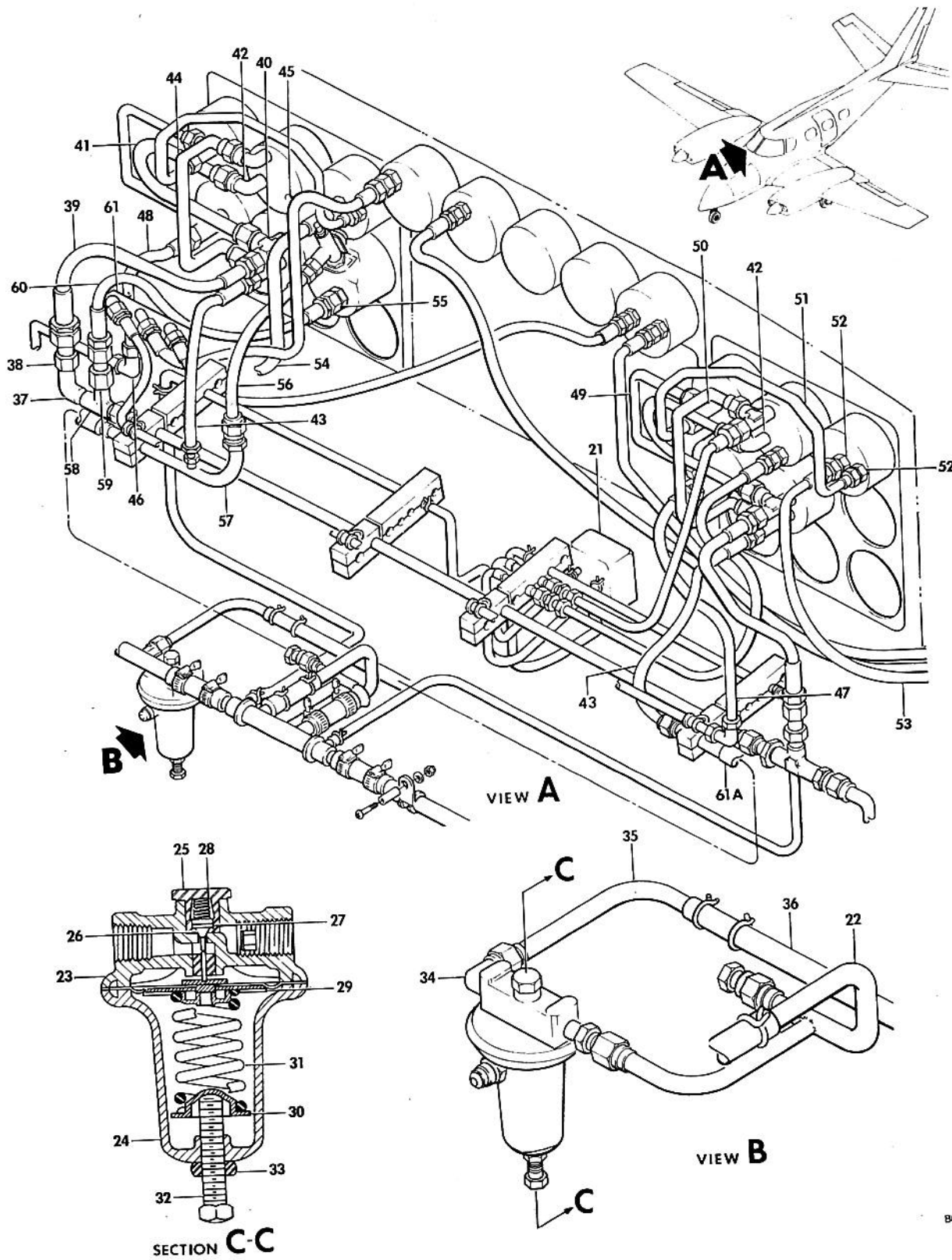

B60-393-3

FIGURE 10-20. INSTRUMENT PANEL PLUMBING  
/SHEET 2 OF 3 SHEETS/

REVISED  
01/08/82

B E E C H C R A F T  
DUKE B60  
I L L U S T R A T E D P A R T S C A T A L O G

SUB-SECT UNIT & ITEM NO.	PART NO.	DESCRIPTION	UNITS PER ASSY	USABLE ON CODE
		1 2 3 4 5 6 7		
10-20 - 21	96-384013-1	. GAGE INSTRUMENT PRESSURE. . . . .	1	
- 22	60-320000-281	. TUBE ASSY, INSTRUMENT PRESSURE /WELDED/. . . . .	1	
	50-324377-13	. VALVE ASSY, AIR PRESSURE REGULATING. . . . .	1	
	AN960-3	. . WASHER. . . . .	2	
- 23	1B7971	. . BODY, VALVE. . . . .	1	
- 24	2B7974	. . BONNET, REGULATOR. . . . .	1	
	1B7839	. . /ATTACHING PARTS/ . . SCREW . . . . .	6	
- 25	1E2268	. . PLUG, BODY . . . . .	1	
- 26	1D5604	. . VALVE & STEM, INNER. . . . .	1	
- 27	1E5322	. . SEAT, VALVE SPRING . . . . .	1	
- 28	1B7979	. . SPRING, VALVE. . . . .	1	
- 29	1B7980	. . DIAPHRAGM . . . . .	1	
- 30	1B7985	. . SEAT, UPPER SPRING . . . . .	1	
- 31	1B7883	. . SPRING, REGULATOR. . . . .	1	
- 32	1B7986	. . SCREW, ADJUSTING . . . . .	1	
- 33	1A9463	. . NUT, ADJUSTING SCREW LOCK. . . . .	1	
- 34	R 60-320000-239	. ELBOW/STA. 119.00 THRU STA. 127.50/. . . . .	1	1
	R 60-320000-335	. ELBOW . . . . .	1	2
- 35	60-320000-241	. TUBE ASSY, INSTRUMENT PRESSURE . . . . .	1	
- 36	60-320000-271	. TUBE ASSY, INSTRUMENT PRESSURE . . . . .	1	
	130292A10	. CLAMP . . . . .	2	
- 37	AN916-3D	. ELBOW . . . . .	1	
- 38	AN816-6-6D	. NIPPLE. . . . .	1	
- 39	AN6270-6-16 1/2	. HOSE, LH AND RH GYRO VENT. . . . .	1	
- 40	MS20826-6D	. TEE /FOR THE RIGHT SIDE/. . . . .	2	
- 41	60-320000-73	. TUBE ASSY, DIRECTIONAL GYRO. . . . .	2	
- 42	MS20822-6D	. ELBOW . . . . .	2	
- 43	AN6270-6-16 1/2	. HOSE, DIRECT GYRO /LH AND RH/. . . . .	1	
- 44	60-320000-71	. TUBE ASSY, GYRO HORIZON. . . . .	1	
- 45	AN913-1D	. PLUG. . . . .	2	
- 46	AN821-4D	. ELBOW, STATIC /LH AND RH/. . . . .	1	
- 47	AN6270-4-19	. HOSE, LH STATIC AIR VENT . . . . .	1	
- 48	AN6270-4-20	. HOSE, RH STATIC AIR VENT . . . . .	1	
- 49	60-320000-75	. TUBE ASSY /ALTIMETER TO RATE OF CLIMB INDICATOR/. . . . .	2	
- 50	MS20826-4D	. TEE . . . . .	2	
- 51	60-320000-77	. TUBE ASSY /AIRSPEED INDICATOR TO ALTIMETER/. . . . .	2	
- 52	AN816-4D	. NIPPLE. . . . .	2	
- 53	AN6270-4-16	. HOSE, LH AIRSPEED INDICATOR. . . . .	1	
- 54	AN6270-4-19	. HOSE, RH AIRSPEED INDICATOR. . . . .	1	
- 55	AN816-4D	. NIPPLE, TURN & SLIP INDICATOR. . . . .	2	
- 56	AN6270-4-15	. HOSE, TURN & SLIP INDICATOR. . . . .	1	
- 57	60-320000-297	. WELDED ASSY, TUBE INSTRUMENT PRESSURE. . . . .	1	
- 58	MS20826-8D	. TEE . . . . .	1	
- 59	8-4TRTX-D	. REDUCER . . . . .	1	
	AN818-8D	. NUT . . . . .	1	
- 60	AN6270-4-17 1/2	. HOSE, TURN & SLIP INDICATOR. . . . .	1	
- 61	60-320000-135	. SUPPORT, INSTRUMENT PRESSURE TUBE. . . . .	2	
- 61A R	60-320000-247	. TUBE ASSY, INSTRUMENT PRESSURE . . . . .	1	

BEECHCRAFT  
DUKE B60  
ILLUSTRATED PARTS CATALOG

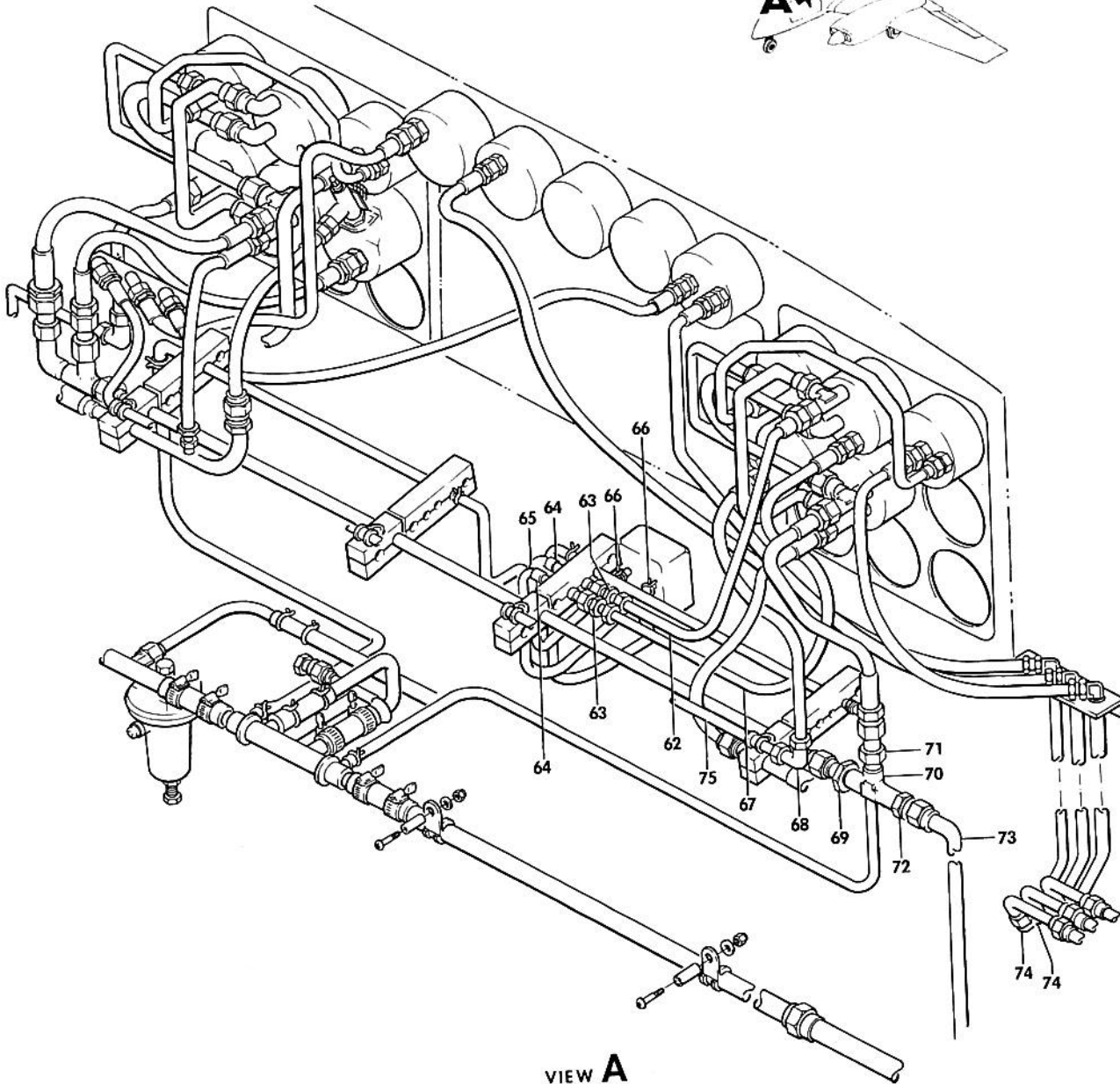
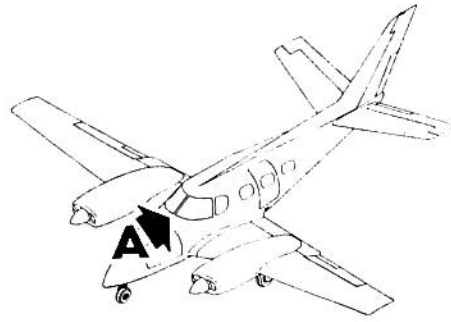

B60-393-4



B E E C H C R A F T  
DUKE B60  
I L L U S T R A T E D P A R T S C A T A L O G

GAMA/ATA CODE & INDEX NO.	PART NO.	DESCRIPTION							UNITS PER ASSY	USABLE ON CODE
		1	2	3	4	5	6	7		
10-20	1/4 X 1/8-268P	.	.	.	.	.	.	.	2	
- 62	60-320000-267	.	.	.	.	.	.	.	1	
- 63	1/4 262PC	.	.	.	.	.	.	.	3	
- 64	60-320000-263	.	.	.	.	.	.	.	1	
- 65	60-320000-129	.	.	.	.	.	.	.	2	
- 66	130292A8	.	.	.	.	.	.	.	4	
- 67	60-320000-257	.	.	.	.	.	.	.	1	
- 68	AN821-4D	.	.	.	.	.	.	.	1	
- 69	8-8FTX-D	.	.	.	.	.	.	.	1	
- 70	AN917-4D	.	.	.	.	.	.	.	1	
- 71	AN816-68D	.	.	.	.	.	.	.	1	
- 72	AN816-10D	.	.	.	.	.	.	.	1	
- 73	60-320000-253	.	.	.	.	.	.	.	1	
- 74	AN833-4D	.	.	.	.	.	.	.	3	
	AN837-4D	.	.	.	.	.	.	.	3	
	AN960-716L	.	.	.	.	.	.	.	3	
	AN924-4D	.	.	.	.	.	.	.	3	
- 75	60-320000-217	.	.	.	.	.	.	.	1	

CODES OF EFFECTIVITY

1 P-247 THRU P-541      2 P-542 AND AFTER



BEECHCRAFT  
DUKE B60  
ILLUSTRATED PARTS CATALOG

39-10-30  
INSTRUMENT PANEL PLUMBING /DUAL/

BEECHCRAFT  
DUKE B60  
ILLUSTRATED PARTS CATALOG

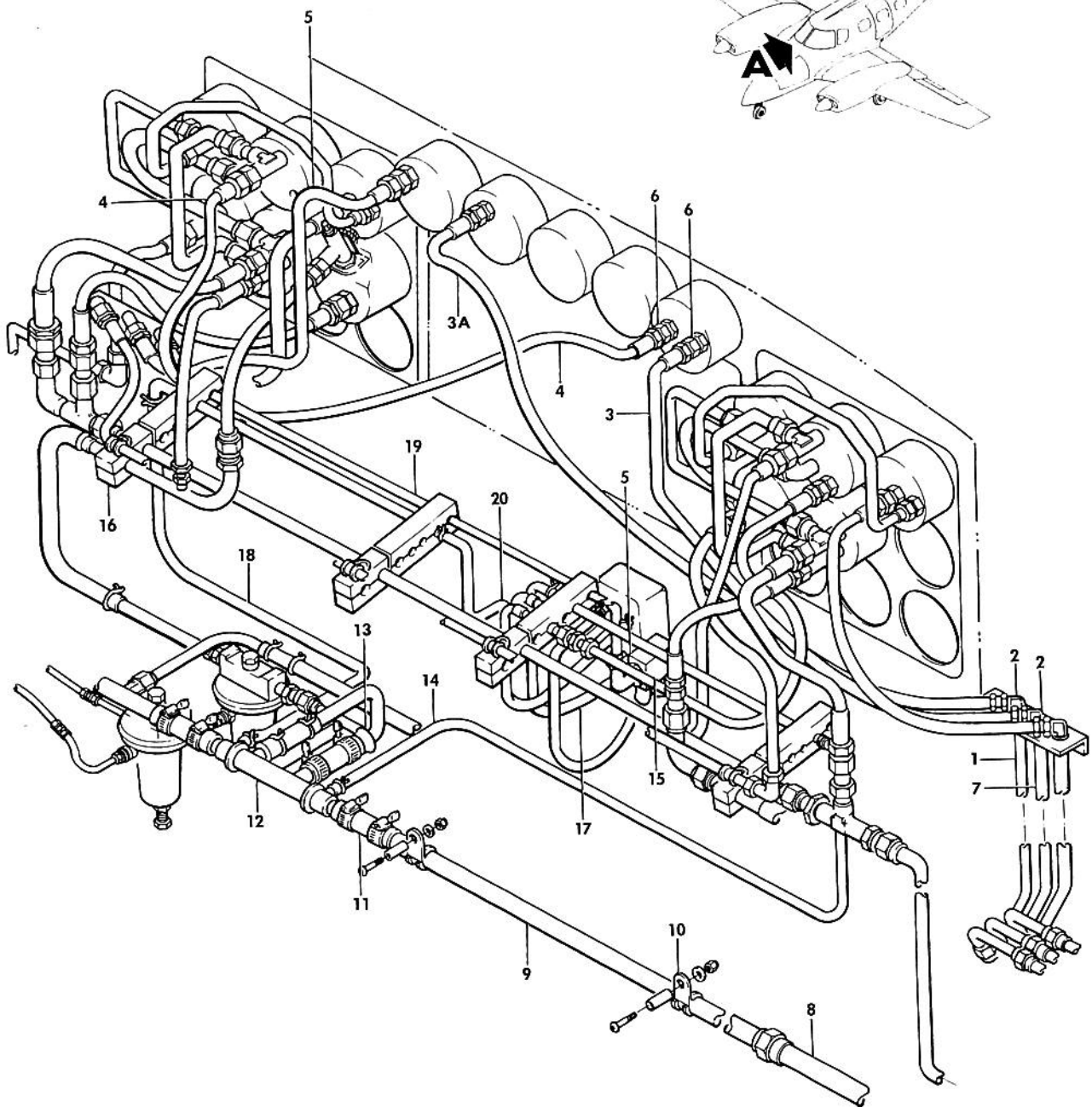
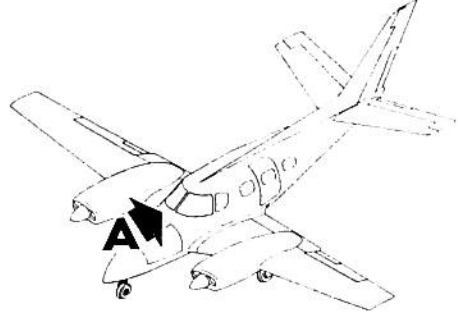

VIEW A

B60-393-5

B E E C H C R A F T  
DUKE B60  
I L L U S T R A T E D P A R T S C A T A L O G

GAMA/ATA CODE & INDEX NO.	PART NO.	DESCRIPTION							UNITS PER ASSY	USABLE ON CODE
		1	2	3	4	5	6	7		
10-30	60-320000-307	PLUMBING INSTL,DUAL INSTRUMENT PANEL /OPTIONAL/							NP	
	60-320000-309	PLUMBING INSTL,DUAL INSTRUMENT PANEL /OPTIONAL/							NP	
- 1	60-320000-19	• TUBE ASSY,MANIFOLD PRESSURE . . . . .							1	
	60-320000-20	• TUBE ASSY,MANIFOLD PRESSURE . . . . .							1	
- 2	AN833-4D	• ELBOW,BULKHEAD /LH AND RH/. . . . .							2	
	AN924-4D	• NUT . . . . .							2	
	AN960-716	• WASHER. . . . .							2	
- 3	AN6270-4-24	• HOSE,LH MANIFOLD PRESSURE . . . . .							1	
- 3A	AN6270-4-33	• HOSE,LH OIL PRESSURE. . . . .							1	
- 4	60-320000-269	• HOSE,RH MANIFOLD PRESSURE . . . . .							1	
- 5	AN6270-4-24	• HOSE,RH OIL PRESSURE. . . . .							1	
- 6	AN816-4D	• NIPPLE,MANIFOLD PRESSURE. . . . .							4	
- 7	60-320000-17	• TUBE ASSY,MANIFOLD PRESSURE . . . . .							1	
	60-320000-18	• TUBE ASSY,MANIFOLD PRESSURE . . . . .							1	
- 8	60-320000-33	• TUBE ASSY,INSTRUMENT PRESSURE . . . . .							1	
	60-320000-35	• TUBE ASSY,INSTRUMENT PRESSURE . . . . .							1	
- 9	60-320000-37	• TUBE ASSY,INSTRUMENT PRESSURE . . . . .							1	
- 10	MS21919DG10	• CLAMP,LH PRESSURE TUBE. . . . .							2	
		/ATTACHING PARTS/								
	AN520-8R22	• SCREW . . . . .							2	
	AN960-8	• WASHER. . . . .							2	
	100696D-Z0027	• SPACER. . . . .							2	
	130909N28	• NUT . . . . .							2	
		*-----*								
- 11	106200H10-10	• HOSE,PRESSURE MANIFOLD. . . . .							4	
	AN737TW34	• CLAMP,PRESSURE MANIFOLD PRESSURE. . . . .							8	
- 12	1H24-6	• MANIFOLD,PRESSURE . . . . .							1	
- 13	60-320000-25	• PLUG,MANIFOLD . . . . .							1	
- 14	60-320000-57	• TUBE,LH INSTRUMENT PRESSURE . . . . .							1	
	130292A6	• CLAMP,LH & RH INSTRUMENT PRESSURE GAGE. . . . .							2	
- 15	60-320000-139	• TUBE,LH INSTRUMENT PRESSURE GAGE. . . . .							1	
- 16	60-324078-1	• CLAMP,INSTRUMENT PLUMBING . . . . .							4	
		/SELL IN MATCHED SETS/								
R	60-324078-7	• CLAMP,INSTRUMENT PLUMBING . . . . .							4	
		/SELL IN MATCHED SETS/								
		/ATTACHING PARTS/								
	AN520-10R18	• SCREW . . . . .							4	
R	MS24693-275	• SCREW . . . . .							8	
	AN960-10	• WASHER. . . . .							12	
	130909N29	• NUT . . . . .							12	
		*-----*								
- 17	60-320000-129	• HOSE,LH INSTRUMENT PRESSURE . . . . .							1	
	130292A8	• CLAMP . . . . .							8	
- 18	60-320000-55	• TUBE,RH INSTRUMENT PRESSURE GAGE. . . . .							1	
- 19	60-320000-141	• TUBE,RH INSTRUMENT PRESSURE GAGE. . . . .							1	
- 20	60-320000-129	• TUBE,RH INSTRUMENT PRESSURE GAGE. . . . .							1	

BEECHCRAFT  
DUKE B60  
ILLUSTRATED PARTS CATALOG

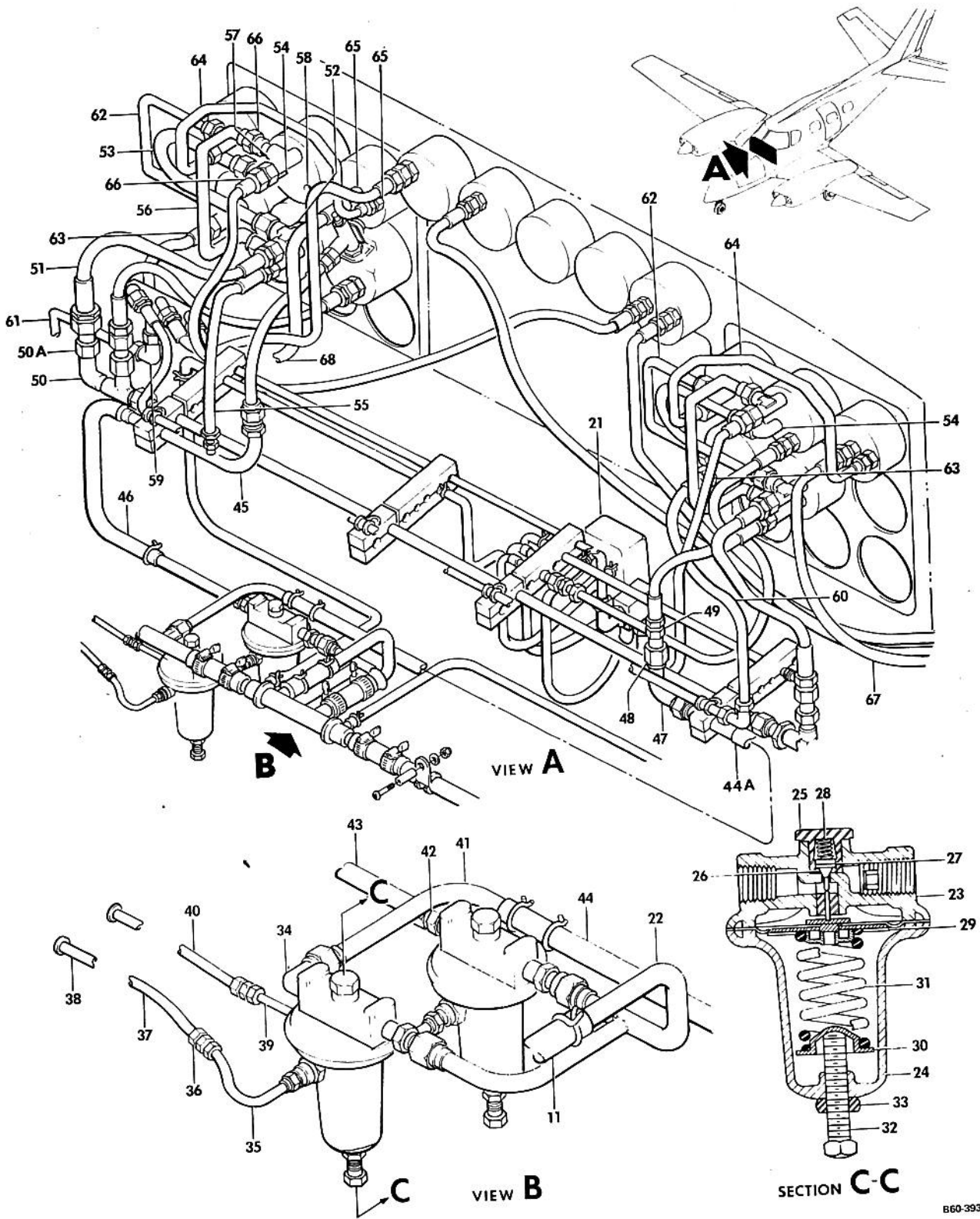

FIGURE 10-30. INSTRUMENT PANEL PLUMBING  
/SHEET 2 OF 3 SHEETS/

B60-393-6

REVISED  
01/08/82

BEECHCRAFT  
DUKE B60  
ILLUSTRATED PARTS CATALOG

GAMA/ATA CODE & INDEX NO.	PART NO.	DESCRIPTION	UNITS PER ASSY	USABLE ON CODE
		1 2 3 4 5 6 7		
10-30 - 21	96-384013-1	. GAGE INSTRUMENT PRESSURE. . . . .	1	
- 22	60-320000-281	. TUBE ASSY, INSTRUMENT PRESSURE /WELDED/. . . . .	1	
	50-324377-13	. VALVE ASSY, AIR PRESSURE REGULATING. . . . .	2	
	50-324377-15	. VALVE ASSY. . . . .	2	
- 23	187971	. BODY, VALVE. . . . .	2	
- 24	287974	. BONNET, REGULATOR. . . . .	2	
	AN960-3	. WASHER. . . . .	2	
	AN816-40	. NIPPLE. . . . .	2	
	1B7839	. /ATTACHING PARTS/ . SCREW . . . . .	1 12	
- 25	1E2268	. PLUG, BODY . . . . .	2	
- 26	1D5604	. VALVE & STEM, INNER. . . . .	2	
- 27	1E5322	. SEAT, VALVE SPRING . . . . .	2	
- 28	187979	. SPRING, VALVE. . . . .	2	
- 29	187980	. DIAPHRAGM . . . . .	2	
- 30	187985	. SEAT, UPPER SPRING . . . . .	2	
- 31	187883	. SPRING REGULATOR. . . . .	2	
- 32	187986	. SCREW, ADJUSTING SCREW LOCK. . . . .	2	
- 33	1A9463	. NUT, ADJUSTING SCREW LOCK. . . . .	2	
- 34	60-320000-239	. ELBOW . . . . .	1	
- 35	60-320000-287	. TUBE ASSY, INSTRUMENT PRESSURE . . . . .	1	
- 36	1/4 262PC	. UNION . . . . .	2	
- 37	60-320000-251	. TUBE, INSTRUMENT PRESSURE. . . . .	1	
- 38	MS35489-6	. GROMMET . . . . .	2	
- 39	60-320000-288	. TUBE ASSY, INSTRUMENT PRESSURE . . . . .	1	
- 40	60-320000-249	. TUBE, INSTRUMENT PRESSURE. . . . .	1	
- 41	60-320000-241	. TUBE ASSY, INSTRUMENT PRESSURE . . . . .	1	
- 42	60-320000-289	. NIPPLE, INSTRUMENT PRESSURE. . . . .	3	
- 43	60-320000-245	. TUBE ASSY, INSTRUMENT PRESSURE . . . . .	1	
- 44	60-320000-271	. TUBE, INSTRUMENT PRESSURE. . . . .	1	
	130292A10	. CLAMP . . . . .	2	
- 44A R	60-320000-247	. TUBE ASSY, INSTRUMENT PRESSURE . . . . .	1	
- 45	60-320000-297	. WELD ASSY, TUBE INSTRUMENT PRESSURE. . . . .	1	
- 46	60-320000-273	. TUBE, INSTRUMENT PRESSURE. . . . .	1	
	130292A10	. CLAMP . . . . .	2	
- 47	AN821-8D	. ELBOW . . . . .	1	
- 48	AN818-8D	. NUT . . . . .	1	
- 49	8-6TRTX-D	. REDUCER . . . . .	1	
- 50	AN916-3D	. ELBOW . . . . .	1	
- 50A	AN816-6-6D	. NIPPLE. . . . .	1	
- 51	AN6270-6-16 1/2	. HOSE, LH & RH GYRO VENT. . . . .	1	
- 52	MS20826-6D	. TEE . . . . .	2	
- 53	60-320000-73	. TUBE ASSY, DIRECTIONAL GYRO. . . . .	2	
- 54	MS20822-6D	. ELBOW . . . . .	2	
- 55	AN6270-6-16 1/2	. HOSE, DIRECT GYRO /LH AND RH/. . . . .	1	
- 56	60-320000-71	. TUBE ASSY, GYRO HORIZON. . . . .	2	
- 57	60-320000-261	. TEE . . . . .	2	
- 58	AN913-1D	. PLUG. . . . .	3	
- 59	AN821-4D	. ELBOW, STATIC AIR VENT /LH & RH/. . . . .	1	
- 60	AN6270-4-24	. HOSE, LH STATIC AIR VENT . . . . .	1	
- 61	AN6270-4-24	. HOSE, RH STATIC AIR VENT . . . . .	1	
- 62	60-320000-75	. TUBE ASSY /ALTIMETER TO RATE OF CLIMB INDICATOR/. . . . .	2	
- 63	MS20826-4D	. TEE . . . . .	2	
- 64	60-320000-77	. TUBE ASSY, AIRSPEED INDICATOR TO ALTIMETER . . . . .	2	
- 65	AN816-4D	. NIPPLE. . . . .	2	
- 66	1/4 - 1/8 268P	. UNION . . . . .	3	
- 67	AN6270-4-18	. HOSE, LH AIRSPEED INDICATOR. . . . .	1	
- 68	AN6270-4-18	. HOSE, RH AIRSPEED INDICATOR. . . . .	1	

BEECHCRAFT  
DUKE B60  
ILLUSTRATED PARTS CATALOG

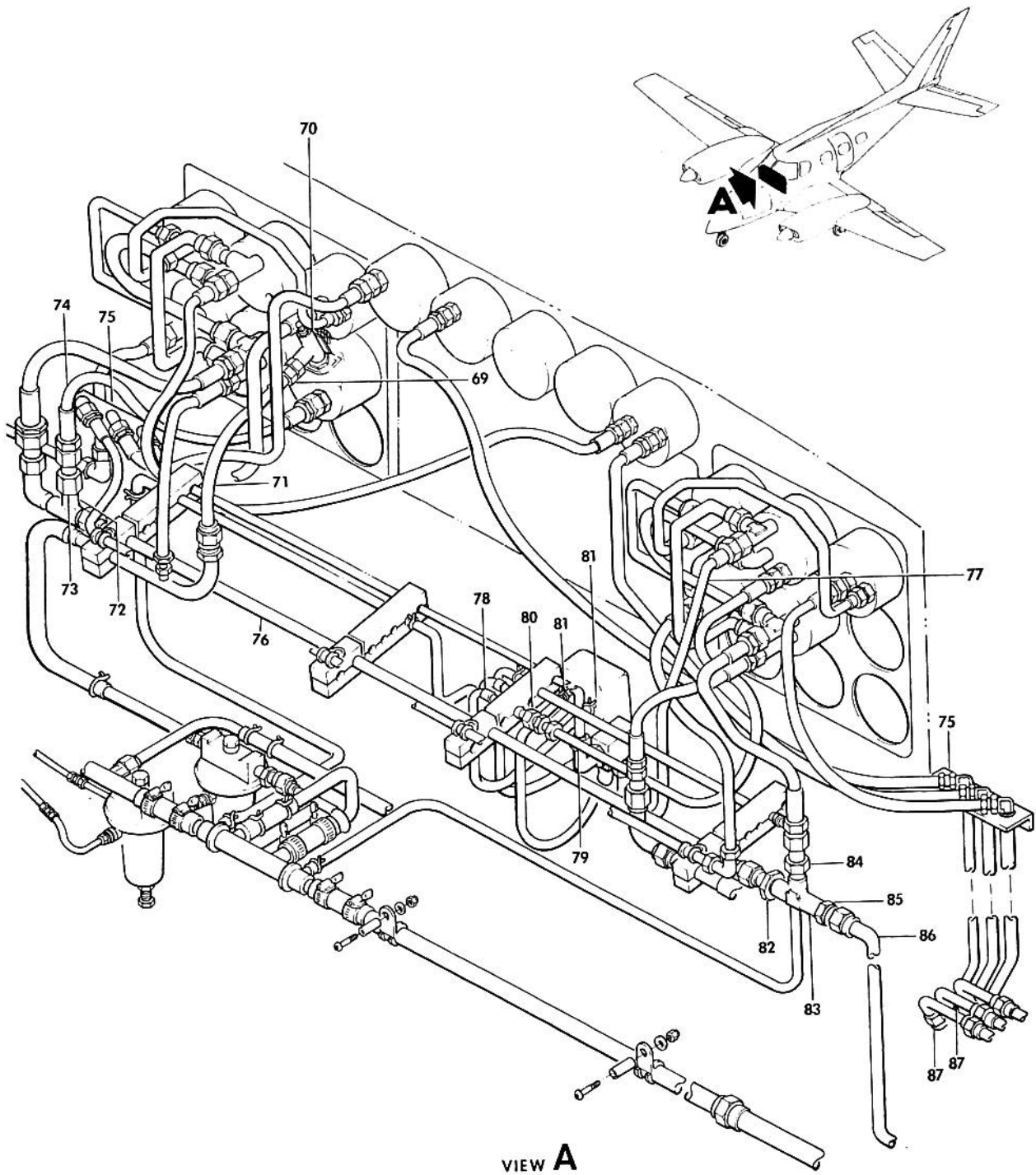

B60-393-7

FIGURE 10-30. INSTRUMENT PANEL PLUMBING  
/SHEET 3 OF 3 SHEETS/

REVISED  
04/16/82



B E E C H C R A F T  
DUKE B60  
I L L U S T R A T E D P A R T S C A T A L O G

SUB-SECT UNIT & ITEM NO.	PART NO.	DESCRIPTION	1	2	3	4	5	6	7	UNITS PER ASSY	USABLE ON CODE
10-30 - 69	AN911-1D	• NIPPLE,TURN & SLIP INDICATOR.	.	.	.	.	.	.	.	1	1
	AN816-4D	• NIPPLE,TURN & SLIP INDICATOR.	.	.	.	.	.	.	.	1	2
- 70	101-384110-1	• VALVE,INSTRUMENT VACUUM CONTROL	.	.	.	.	.	.	.	1	1
	AN816-4D	• NIPPLE.	.	.	.	.	.	.	.	1	1
	AN913-1D	• PLUG.	.	.	.	.	.	.	.	1	1
	3400X2	• ELBOW,STREET.	.	.	.	.	.	.	.	1	1
- 71	AN6270-4-18	• HOSE,TURN & SLIP INDICATOR.	.	.	.	.	.	.	.	1	1
- 72	MS20826-8D	• TEE	.	.	.	.	.	.	.	1	
- 73	8-4TRTX-D	• REDUCER	.	.	.	.	.	.	.	1	
	AN818-8D	• NUT	.	.	.	.	.	.	.	1	
- 74	AN6270-4-18	• HOSE,TURN & SLIP INDICATOR.	.	.	.	.	.	.	.	1	
	AN816-4D	• NIPPLE,TURN & SLIP INDICATOR.	.	.	.	.	.	.	.	1	
- 75	60-320000-135	• SUPPORT,INSTRUMENT PRESSURE TUBE.	.	.	.	.	.	.	.	2	
- 76	60-320000-255	• TUBE ASSY,TURN & SLIP INDICATOR	.	.	.	.	.	.	.	1	
- 77	60-320000-267	• TUBE,GYRO HORIZON TO PRESSURE GAGE.	.	.	.	.	.	.	.	1	
- 78	60-320000-263	• TUBE,GYRO HORIZON	.	.	.	.	.	.	.	1	
- 79	60-320000-257	• TUBE,GYRO HORIZON TO PRESSURE GAGE.	.	.	.	.	.	.	.	1	
- 80	1/4-262PC	• UNION	.	.	.	.	.	.	.	1	
- 81	130292A8	• CLAMP	.	.	.	.	.	.	.	4	
- 82	8-8FTX-D	• CONNECTOR	.	.	.	.	.	.	.	1	
- 83	AN917-4D	• TEE	.	.	.	.	.	.	.	3	
- 84	AN816-6-8D	• NIPPLE.	.	.	.	.	.	.	.	1	
	AN913-4D	• PLUG /USE WITH 60-320000-309 INSTL/	.	.	.	.	.	.	.	1	
- 85	AN816-10D	• CONNECTOR	.	.	.	.	.	.	.	1	
- 86	60-320000-253	• TUBE ASSY,INSTRUMENT PRESSURE VENT.	.	.	.	.	.	.	.	1	
- 87	AN833-4D	• ELBOW,LH PITOT PRESSURE TUBE.	.	.	.	.	.	.	.	3	
	AN837-4D	• ELBOW,RH PITOT PRESSURE TUBE.	.	.	.	.	.	.	.	3	
	AN960-716L	• WASHER /LH AND RH/.	.	.	.	.	.	.	.	3	
	AN924-4D	• NUT /LH AND RH/	.	.	.	.	.	.	.	3	

CODES OF EFFECTIVITY

1 P-247 THRU P-596      2 P-597 AND AFTER



BEECHCRAFT  
DUKE B60  
ILLUSTRATED PARTS CATALOG

39-10-40  
INSTRUMENT SUBPANEL ASSEMBLY

BEECHCRAFT  
DUKE B60  
ILLUSTRATED PARTS CATALOG

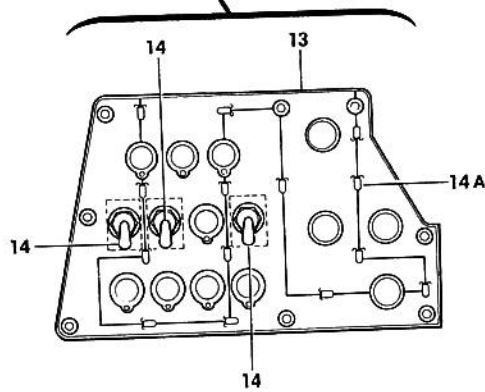
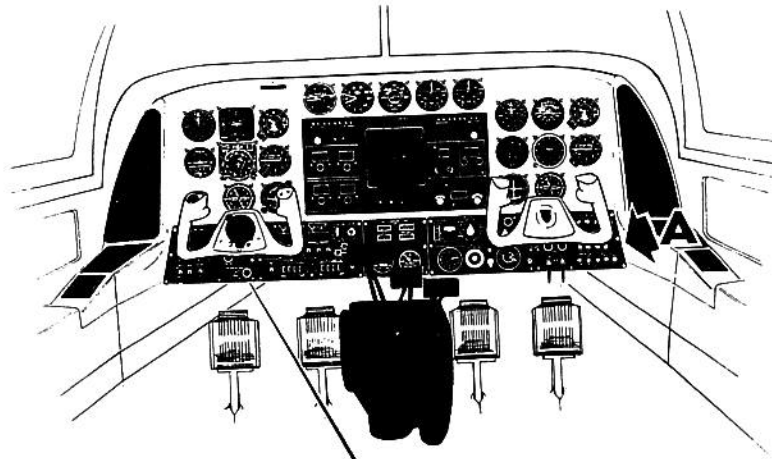
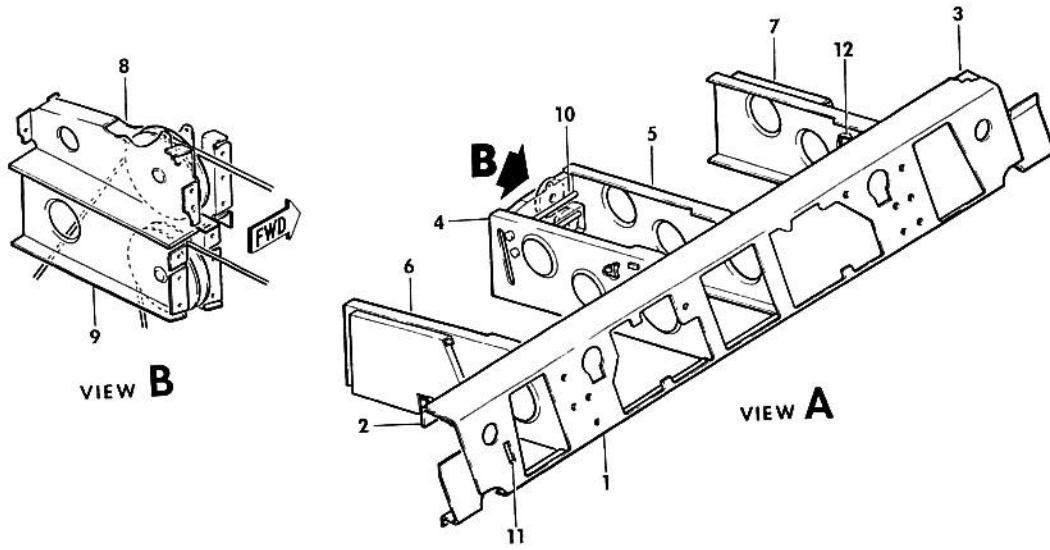

B60-395-13

FIGURE 10-40. SUBPANEL ASSY, INSTRUMENT  
/SHEET 1 OF 7 SHEETS/

B E E C H C R A F T  
DUKE B60  
I L L U S T R A T E D P A R T S C A T A L O G

GAMA/ATA CODE & INDEX NO.	PART NO.	DESCRIPTION							UNITS PER ASSY	USABLE ON CODE
		1	2	3	4	5	6	7		
10-40	60-324025-601	.	.	.	.	.	.	.	1	
	60-324023-601	.	.	.	.	.	.	.	1	
- 1	60-324023-1	.	.	.	.	.	.	.	1	1
	60-324023-25	.	.	.	.	.	.	.	1	2
	60-324023-17	.	.	.	.	.	.	.	1	
- 2	60-324023-9	.	.	.	.	.	.	.	1	
- 3	60-324023-10	.	.	.	.	.	.	.	1	
	60-324023-21	.	.	.	.	.	.	.	1	
	60-324023-23	.	.	.	.	.	.	.	1	
- 4	60-524049-13	.	.	.	.	.	.	.	1	
- 5	60-524049-14	.	.	.	.	.	.	.	1	
	60-524049-15	.	.	.	.	.	.	.	1	
	60-524049-16	.	.	.	.	.	.	.	1	
	60-524049-17	.	.	.	.	.	.	.	1	
	60-524049-18	.	.	.	.	.	.	.	1	
	NAS697A3	.	.	.	.	.	.	.	1	
	NAS697A04L	.	.	.	.	.	.	.	2	
- 6	60-524049-5	.	.	.	.	.	.	.	12	
- 7	60-524049-6	.	.	.	.	.	.	.	1	
	NAS687A06	.	.	.	.	.	.	.	1	
	NAS696A06L	.	.	.	.	.	.	.	14	
	206PL30	.	.	.	.	.	.	.	2	
		.	.	.	.	.	.	.	NP	
		.	.	.	.	.	.	.		
	206PL45	.	.	.	.	.	.	.	2	
	AN520-10R6	.	.	.	.	.	.	.	4	
	AN960D10L	.	.	.	.	.	.	.	4	
	130909N29	.	.	.	.	.	.	.	4	
	60-320000-135	.	.	.	.	.	.	.	2	
- 8	MS25083-2BE5	.	.	.	.	.	.	.	2	
- 9	60-524141-1	.	.	.	.	.	.	.	1	
	60-524141-3	.	.	.	.	.	.	.	1	
	60-524141-5	.	.	.	.	.	.	.	1	
	60-524141-7	.	.	.	.	.	.	.	1	
	60-524141-9	.	.	.	.	.	.	.	1	
	60-524141-11	.	.	.	.	.	.	.	1	
	AN366F428	.	.	.	.	.	.	.	1	
	NAS697A08	.	.	.	.	.	.	.	1	
	NAS1068A06L	.	.	.	.	.	.	.	2	
- 10	60-324023-19	.	.	.	.	.	.	.	24	
	4532	.	.	.	.	.	.	.	1	
		.	.	.	.	.	.	.	1	
	AN507-6R10	.	.	.	.	.	.	.	2	
	MS27212-1-8	.	.	.	.	.	.	.	3	
	AN515-4R10	.	.	.	.	.	.	.	2	
	NAS696A06L	.	.	.	.	.	.	.	30	
	114675C1-8	.	.	.	.	.	.	.	2	
- 11	114675A1-8	.	.	.	.	.	.	.	1	
	60-530198-1	.	.	.	.	.	.	.	2	
- 12	MK1000-632	.	.	.	.	.	.	.	1	
	MA751T250	.	.	.	.	.	.	.	1	
		.	.	.	.	.	.	.	2	
	AN520-10R6	.	.	.	.	.	.	.	2	
	AN960-10L	.	.	.	.	.	.	.	2	
	60-324026-603	.	.	.	.	.	.	.	1	
- 13	60-324093	.	.	.	.	.	.	.	1	
- 14	35-380053-7	.	.	.	.	.	.	.	3	
	35-380052	.	.	.	.	.	.	.	3	
- 14A	D158-100-5T1	.	.	.	.	.	.	.	14	

BEECHCRAFT  
DUKE B60  
ILLUSTRATED PARTS CATALOG

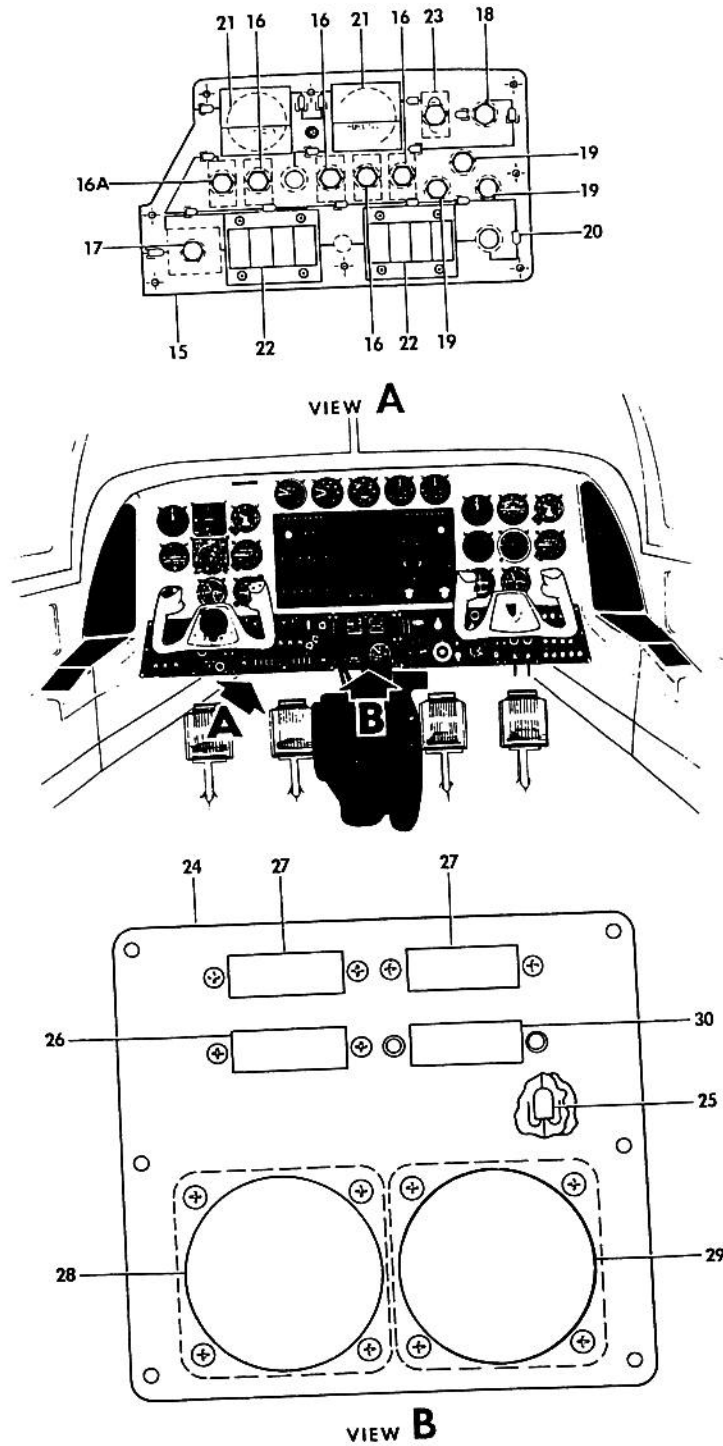

B60-395-9

FIGURE 10-40. SUBPANEL ASSY, INSTRUMENT  
/SHEET 2 OF 7 SHEETS/

REVISED  
01/08/82

BEECHCRAFT  
DUKE 860  
ILLUSTRATED PARTS CATALOG

GAMA/ATA CODE & INDEX NO.	PART NO.	DESCRIPTION	UNITS PER ASSY	USABLE ON CODE
		1 2 3 4 5 6 7		
10-40	60-324037-603	• PRINTED CIRCUIT BOARD ASSY,LH INBD.	1	
- 15	60-324032	• • PRINTED CIRCUIT BOARD	1	
- 16	R 35-380053-7	• • SWITCH.	3	
- 16A	R 35-380053-19	• • SWITCH.	2	
- 17	35-380053-9	• • SWITCH.	1	
- 18	MS25041-2	• • LIGHT ASSY,LANDING GEAR /UNLOCKED/.	1	
- 19	MS25041-3	• • LIGHT ASSY.	3	
	MS25237-327	• • BULB,LIGHT.	4	
- 20	D158-100-5T1	• • LIGHT /WHITE/	16	
- 21	60-384034-5	• • INDICATOR,FUEL QUANTITY	2	
	60-364025-1	• • SWITCH ASSY,LH THUMB WHEEL DIMMING.	1	
	60-364025-3	• • SWITCH ASSY,RH THUMB WHEEL DIMMING.	1	
	60-364025-5	• • SWITCH ASSY,LH PANEL LIGHT.	1	
	60-364025-7	• • SWITCH ASSY,INSTR FLOOD LIGHTS/RED/	1	
	60-364025-9	• • SWITCH ASSY,RH PANEL LIGHT.	1	
	60-364025-11	• • SWITCH ASSY,INSTR FLOOD LIGHTS/WHITE/	1	
	60-364025-13	• • SWITCH ASSY,ENGINE INSTR LIGHTS	1	
	60-364025-15	• • SWITCH ASSY,SUBPANEL LIGHTS	1	
	60-364025-17	• • SWITCH ASSY,RADIO LIGHTS.	1	
	60-364025-19	• • SWITCH ASSY,PEDESTAL LIGHTS	1	
- 22	MTD200-384	• • SWITCH,THUMB WHEEL DIMMING.	1	
	MTD27576	• • SWITCH.	4	
	TM100S32-4	• • FRAME	1	
	TM100-2793-4	• • ESCUTCHEON PLATE.	1	
- 23	8857K44	• • SWITCH,LANDING GEAR	1	
	60-324110-1	• • BRACKET ASSY,FUEL QUANTITY GAGE /ATTACHING PARTS/	1	
	AN507B632R7	• • SCREW	1	
	AN936A6	• • WASHER.	1	
	AN340B6	• • NUT	1	
	35-380052	• • KNOB,TOGGLE SWITCH.	6	
R	96-324181	• • PRINTED CIRCUIT BOARD ASSY,FUEL QTY GAGE.	1	22
R	60-364066-1	• • PRINTED CIRCUIT BOARD ASSY,FUEL QTY GAGE.	1	23
	60-324101-601	• • PRINTED CIRCUIT BOARD ASSY,SUBPANEL	1	
- 24	60-324102	• • PRINTED CIRCUIT BOARD	1	
- 25	D158-100-5T1	• • LIGHT /WHITE/	15	
- 26	60-384038	• • VOLTMETER /ATTACHING PARTS/	1	
	MS246938B25	• • SCREW	2	
	AN960D6L	• • WASHER.	2	
	MS20365D632	• • NUT	2	
- 27	60-384021	• • AMMETER /ATTACHING PARTS/	2	
	MS246938B25	• • SCREW	2	
	AN960D6L	• • WASHER.	2	
	MS20365D632	• • NUT	2	
- 28	96-384013-1	• • INDICATOR,GYRO PRESSURE	1	8
	96-384013-3	• • GAGE,INSTRUMENT AIRPRESSURE /ATTACHING PARTS/	1	14
	MS246938B28	• • SCREW	4	
- 29	50-380105-3	• • GAGE,PNEUMATIC PRESSURE/OPTIONAL/	1	
- 30	60-384023-1	• • AMMETER,PROPELLER DEICE/OPTIONAL/	1	

BEECHCRAFT  
DUKE B60  
ILLUSTRATED PARTS CATALOG

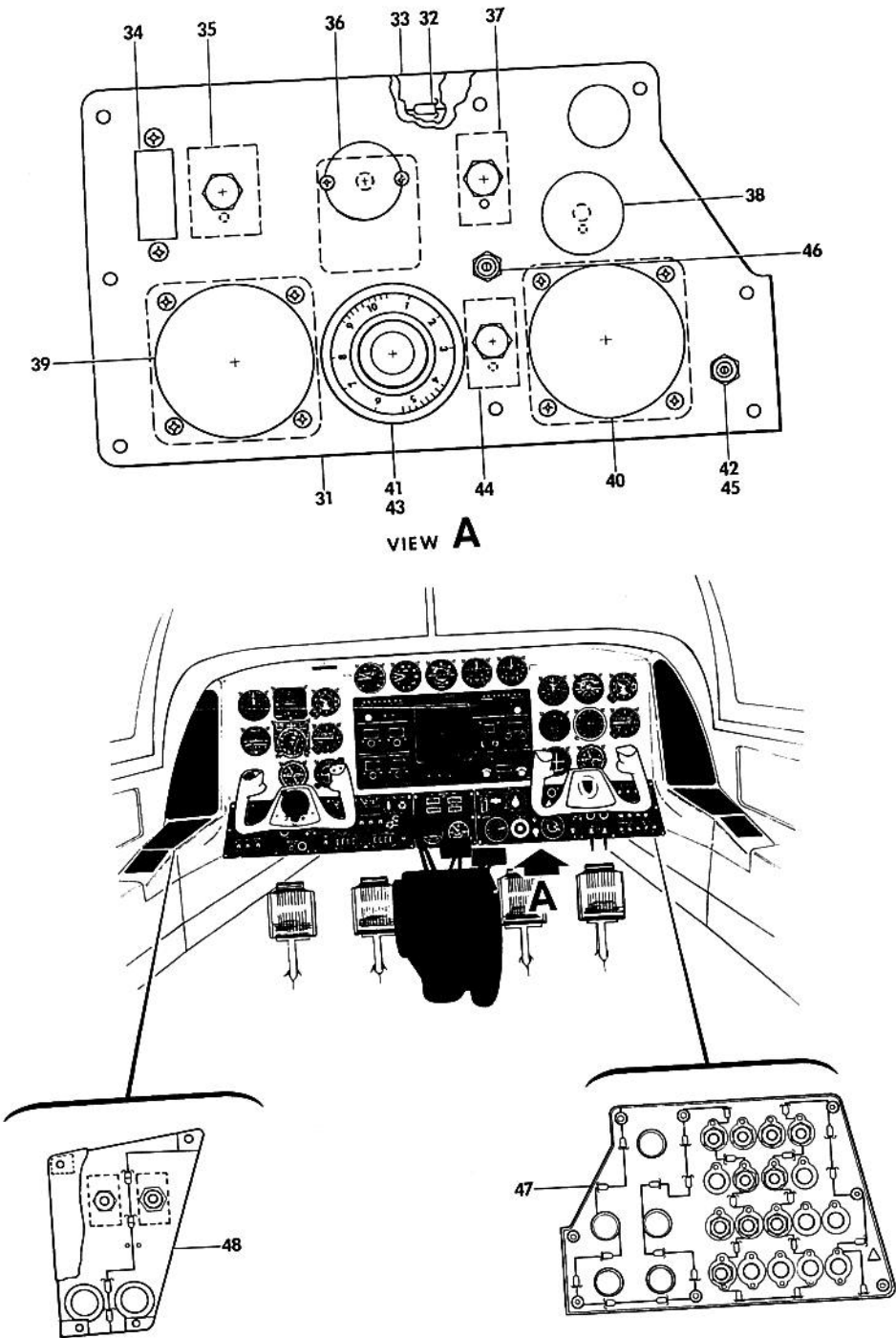

B60-395-10



B E E C H C R A F T  
DUKE B60  
I L L U S T R A T E D P A R T S C A T A L O G

GAMA/ATA CODE & INDEX NO.	PART NO.	DESCRIPTION							UNITS PER ASSY	USABLE ON CODE
		1	2	3	4	5	6	7		
10-40 - 31	60-324098-601	•	•	•	•	•	•	•	1	1
	60-324164-601	•	•	•	•	•	•	•	1	2
- 32	D158-100-5T1	•	•	•	•	•	•	•	19	1
	D158-100-5T1	•	•	•	•	•	•	•	18	2
- 33	60-324099	•	•	•	•	•	•	•	1	1
	60-324165-1	•	•	•	•	•	•	•	1	2
- 34	60-324161-1	•	•	•	•	•	•	•	1	
		•	•	•	•	•	•	•	1	
- 35	8906K1445	•	•	•	•	•	•	•	1	
- 36	60-364041-1	•	•	•	•	•	•	•	1	
	60-364041-3	•	•	•	•	•	•	•	1	
- 37	35-380053-1	•	•	•	•	•	•	•	1	
	35-380052	•	•	•	•	•	•	•	1	
- 38	0115	•	•	•	•	•	•	•	1	
- 39	50-380045	•	•	•	•	•	•	•	1	
	MS24693BB25	•	•	•	•	•	•	•	3	
	AN960D6L	•	•	•	•	•	•	•	4	
	MS20365D632	•	•	•	•	•	•	•	3	
- 40	50-380046-3	•	•	•	•	•	•	•	1	
	MS24693BB25	•	•	•	•	•	•	•	4	
	AN960D6L	•	•	•	•	•	•	•	4	
	MS20365D632	•	•	•	•	•	•	•	4	
- 41	130374-2	•	•	•	•	•	•	•	1	2
	MS24693BB30	•	•	•	•	•	•	•	4	
- 42	2TL1-50K	•	•	•	•	•	•	•	1	2
	MS24693BB30	•	•	•	•	•	•	•	2	
	AN565D8H2	•	•	•	•	•	•	•	1	
	MS35206-299	•	•	•	•	•	•	•	2	2
- 43	3275-00-1	•	•	•	•	•	•	•	1	1
	4344-00-72	•	•	•	•	•	•	•	1	1
	MS24693S28	•	•	•	•	•	•	•	4	
- 44	MS25125C3	•	•	•	•	•	•	•	1	1
- 45	2TL1-50M	•	•	•	•	•	•	•	1	1
- 46	PM6	•	•	•	•	•	•	•	1	1
- 47	60-324095-601	•	•	•	•	•	•	•	1	1
- 48	60-324127-603	•	•	•	•	•	•	•	1	

BEECHCRAFT  
DUKE B60  
ILLUSTRATED PARTS CATALOG

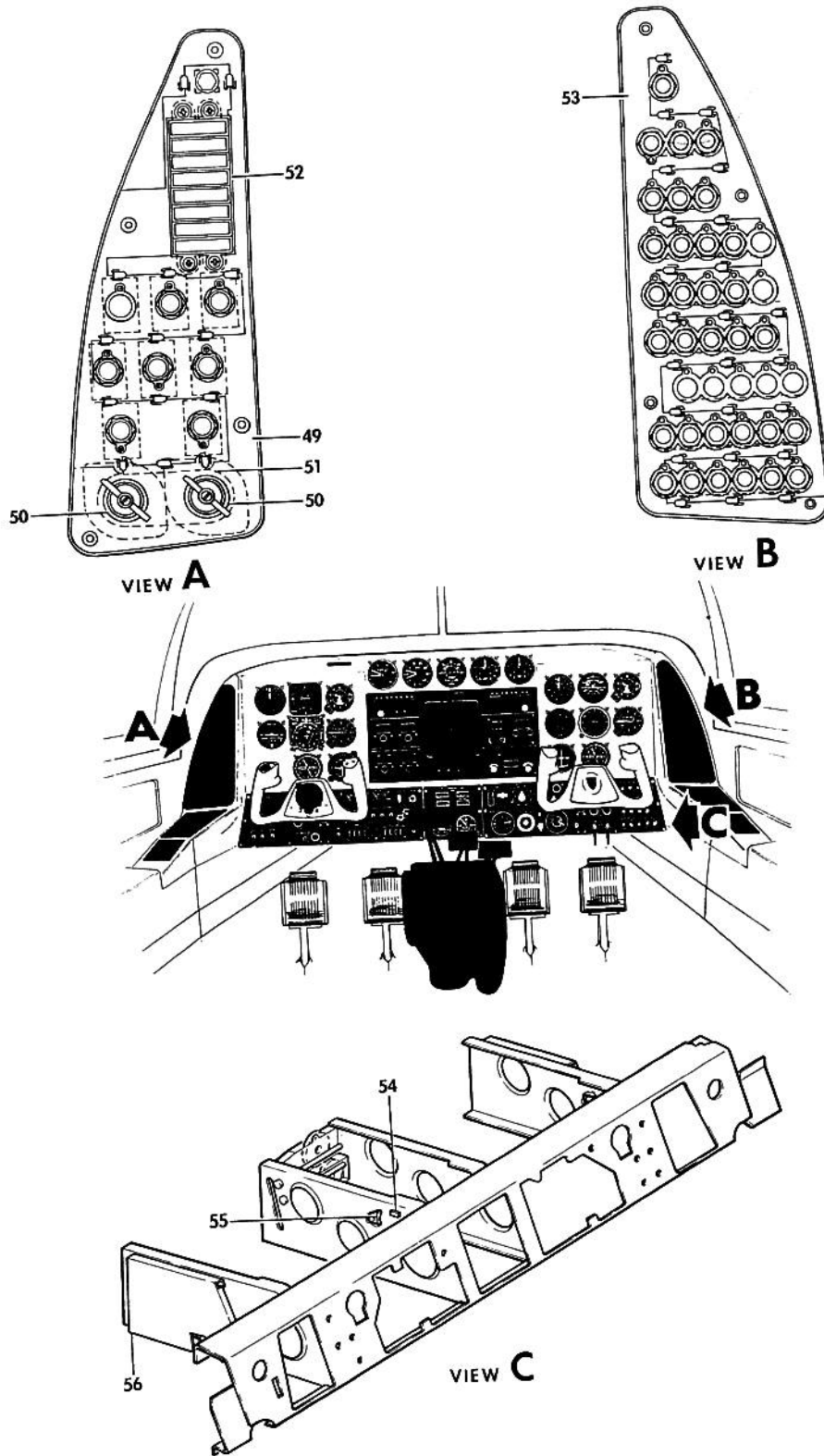

B60-395-11

B E E C H C R A F T  
DUKE 860  
I L L U S T R A T E D P A R T S C A T A L O G

GAMA/ATA CODE & INDEX NO.	PART NO.	DESCRIPTION	1 2 3 4 5 6 7							UNITS PER ASSY	USABLE ON CODE
			1	2	3	4	5	6	7		
10-40	60-324124-603	• PRINTED CIRCUIT BOARD ASSY,LH UPPER CONSOLE								1	18
	60-324124-17	• PRINTED CIRCUIT BOARD ASSY,LH UPPER CONSOLE								1	17
- 49	60-324125	• PRINTED CIRCUIT BOARD								1	
- 50	10-357250-1	• SWITCH,IGNITION								2	
- 51	60-324137	• LOCK,KEYWAY								1	
- 52	351-10452-005	• PANEL,ANNUNCIATOR								1	15
	60-384031-1	• PANEL,ANNUNCIATOR								1	16
	60-384031-13	• PANEL,ANNUNCIATOR								1	17
	MS24693S25	/ATTACHING PARTS/ • SCREW								4	
	35-380053-1	• SWITCH/ORDER 8906K3207/								4	19
	8906K3207	• SWITCH,GENERATOR CONTROL								2	
	35-380052	• KNOB								6	
	PM6	• SWITCH								1	
	D158-100-5T1	• LIGHT/WHITE/								14	
- 53	60-324130-603	• PANEL ASSY,RH UPPER CONSOLE								1	
- 54	F108-25 OHM	• RESISTOR								1	
	AN515-4R8	/ATTACHING PARTS/ • SCREW								2	
	AN960-4L	• WASHER								2	
	60-364000-43	• SPACER,TERMINAL BOARD								2	
- 55	60-364000-605	• TERMINAL BOARD ASSY								1	
	AN515-4R10	/ATTACHING PARTS/ • SCREW								4	
	AN960-4L	• WASHER								4	
	50-364295-3	• BUS BAR/SEE WIRING DIAGRAM MANUAL/								2	
	AN935-616L	/ATTACHING PARTS/ • WASHER								6	
	AN960-616L	• WASHER								6	
	MS21045C6	• NUT								6	
	60-369015	• DECAL,HEATER FUEL PUMP FUSE I.D.								1	
	AGC5	• FUSE								3	
	MS25226-2-8	• BUS BAR/SEE WIRING DIAGRAM/								2	
	MS27212-5-6	• TERMINAL BOARD/SEE WIRING DIAGRAM/								1	
- 56	60-364000-617	• PANEL ASSY								1	
	60-364000-601	• PANEL ASSY								1	
	169-380021-9	• WARNING HORN,LANDING GEAR								1	
	3742	• FIXED RESISTOR/3.3 OHM,10 WATT/								1	
	AN515-8R36	/ATTACHING PARTS/ • SCREW								1	
	2163	• FIBER WASHER								2	
	3768	• FIXED RESISTOR/39 OHM,10 WATT/								1	
	AN515-8R36	/ATTACHING PARTS/ • SCREW								1	
	2163	• FIBER WASHER								2	
	60-364000-23	• ANNUNCIATOR DIODE ASSY								1	18
	60-364000-105	• ANNUNCIATOR DIODE ASSY								1	17
	IN4005	• DIODE								9	
	1025-360041-3	• INSULATOR								1	3
	60-364000-95	• INSULATOR								1	4
	60-364000-109	• INSULATOR								1	17
	2200B	• TERMINAL BOARD								1	3
	60-364000-93	• TERMINAL BOARD								1	4
	60-364000-107	• TERMINAL BOARD								1	17
	AN515-4-7	/ATTACHING PARTS/ • SCREW								4	
	AN960-4L	• WASHER								4	
	AN936A4	• WASHER,LOCK								4	
	MS35649-242	• NUT								4	

BEECHCRAFT  
DUKE 860  
ILLUSTRATED PARTS CATALOG

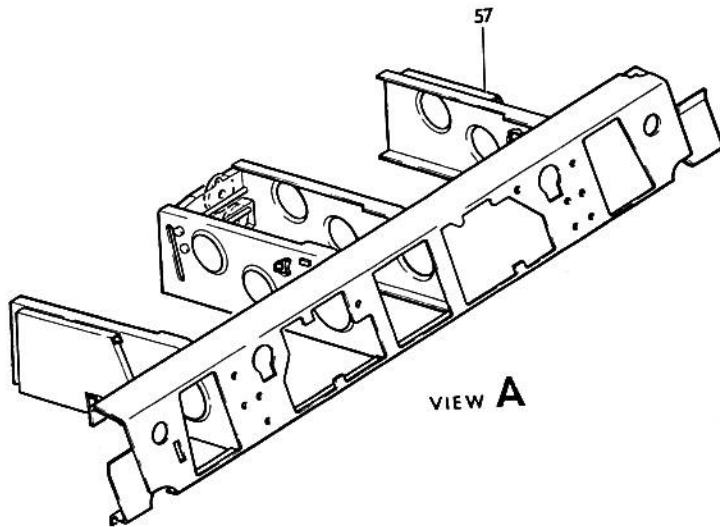
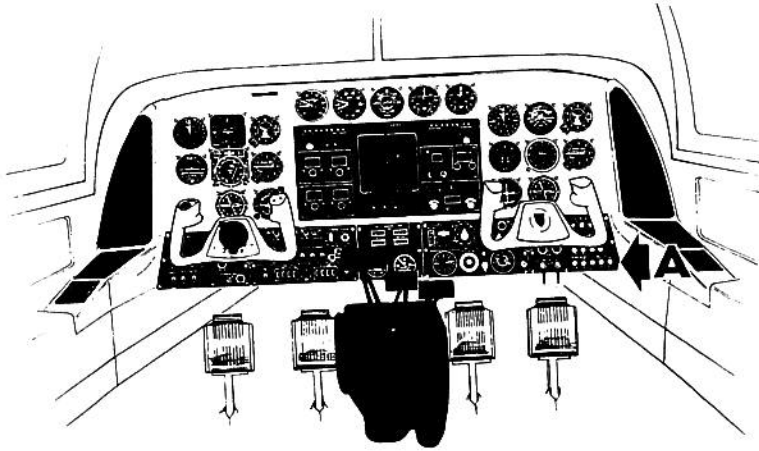

B60-395-16

B E E C H C R A F T  
DUKE B60  
I L L U S T R A T E D P A R T S C A T A L O G

GAMA/ATA CODE & INDEX NO.	PART NO.	DESCRIPTION							UNITS PER ASSY	USABLE ON CODE		
		1	2	3	4	5	6	7				
10-40	R102	. .	. .	. .	. .	. .	. .	. .	. .	1		
	1N4005	. .	. .	. .	. .	. .	. .	. .	. .	3		
	50-380048-1	. .	. .	. .	. .	. .	. .	. .	. .	3		
		/ATTACHING PARTS/									3	
	AN515-6R24	. .	. .	. .	. .	. .	. .	. .	. .	. .	2	
	100696DZB018	. .	. .	. .	. .	. .	. .	. .	. .	. .	4	
	AN960-6L	. .	. .	. .	. .	. .	. .	. .	. .	. .	2	
	*											
	96-364000-3	. .	. .	. .	. .	. .	. .	. .	. .	. .	1	
	96-364000-7	. .	. .	. .	. .	. .	. .	. .	. .	. .	1	
	IN1342	. .	. .	. .	. .	. .	. .	. .	. .	. .	3	
	43-1761	. .	. .	. .	. .	. .	. .	. .	. .	. .	3	
	4373	. .	. .	. .	. .	. .	. .	. .	. .	. .	1	
	7/16A54F25	. .	. .	. .	. .	. .	. .	. .	. .	. .	1	
	MS35207-262	. .	. .	. .	. .	. .	. .	. .	. .	. .	1	
	AN515-4R12	. .	. .	. .	. .	. .	. .	. .	. .	. .	3	
	AN515-6-18	. .	. .	. .	. .	. .	. .	. .	. .	. .	4	
	AN960-6L	. .	. .	. .	. .	. .	. .	. .	. .	. .	4	
	AN515-6R16	. .	. .	. .	. .	. .	. .	. .	. .	. .	4	
	60-364000-618	. .	. .	. .	. .	. .	. .	. .	. .	. .	2	
	60-364000-603	. .	. .	. .	. .	. .	. .	. .	. .	. .	1	
	169-380021-11	. .	. .	. .	. .	. .	. .	. .	. .	. .	1	
	1N4005	. .	. .	. .	. .	. .	. .	. .	. .	. .	1	
	101-384028-3	. .	. .	. .	. .	. .	. .	. .	. .	. .	2	
		/ATTACHING PARTS/									1	
	MS35206-216	. .	. .	. .	. .	. .	. .	. .	. .	. .	2	
	MS21069L04	. .	. .	. .	. .	. .	. .	. .	. .	. .	2	
	*											
	6107	. .	. .	. .	. .	. .	. .	. .	. .	. .	1	
	10-357487-242	. .	. .	. .	. .	. .	. .	. .	. .	. .	1	5
	50-380048-1	. .	. .	. .	. .	. .	. .	. .	. .	. .	1	
		/ATTACHING PARTS/									1	
	MS35206-230	. .	. .	. .	. .	. .	. .	. .	. .	. .	2	
	AN960-6L	. .	. .	. .	. .	. .	. .	. .	. .	. .	2	
	*											
	MS35207-262	. .	. .	. .	. .	. .	. .	. .	. .	. .	4	
	130909B19	. .	. .	. .	. .	. .	. .	. .	. .	. .	4	
	AN960-10L	. .	. .	. .	. .	. .	. .	. .	. .	. .	4	
	AN515-8R	. .	. .	. .	. .	. .	. .	. .	. .	. .	4	
	AN960-8L	. .	. .	. .	. .	. .	. .	. .	. .	. .	2	
35-380053-7	. .	. .	. .	. .	. .	. .	. .	. .	. .	2		
35-380052	. .	. .	. .	. .	. .	. .	. .	. .	. .	1		
7274-2-5	. .	. .	. .	. .	. .	. .	. .	. .	. .	1		
35-380052	. .	. .	. .	. .	. .	. .	. .	. .	. .	1		
AN515B6R12	. .	. .	. .	. .	. .	. .	. .	. .	. .	1		
MS25083-2AB5	. .	. .	. .	. .	. .	. .	. .	. .	. .	38		
	/ATTACHING PARTS/									7		
AN515-8-7	. .	. .	. .	. .	. .	. .	. .	. .	. .	7		
AN960D8L	. .	. .	. .	. .	. .	. .	. .	. .	. .	7		
NAS679A08	. .	. .	. .	. .	. .	. .	. .	. .	. .	7		
*												
60-364000-91	. .	. .	. .	. .	. .	. .	. .	. .	. .	1		
MS35489-4	. .	. .	. .	. .	. .	. .	. .	. .	. .	1		
60-360001-653	. .	. .	. .	. .	. .	. .	. .	. .	. .	1		
MC1A106-16	. .	. .	. .	. .	. .	. .	. .	. .	. .	1		
MS35489-35	. .	. .	. .	. .	. .	. .	. .	. .	. .	2		
AN530-8R6	. .	. .	. .	. .	. .	. .	. .	. .	. .	1		
MS21919DG4	. .	. .	. .	. .	. .	. .	. .	. .	. .	1		
70H10	. .	. .	. .	. .	. .	. .	. .	. .	. .	1		
B2446	. .	. .	. .	. .	. .	. .	. .	. .	. .	4		
WD333	. .	. .	. .	. .	. .	. .	. .	. .	. .	2		
AWG2X3/32	. .	. .	. .	. .	. .	. .	. .	. .	. .	8		
MS3106A20-15S	. .	. .	. .	. .	. .	. .	. .	. .	. .	4		
	/ATTACHING PARTS/									1		

BEECHCRAFT  
DUKE B60  
ILLUSTRATED PARTS CATALOG

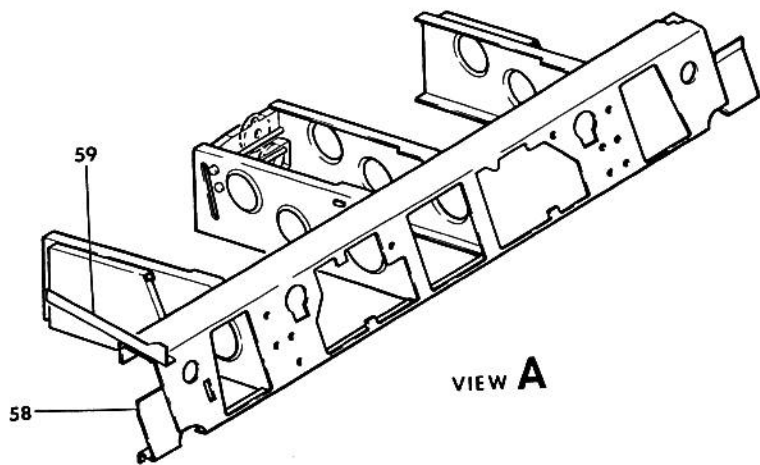
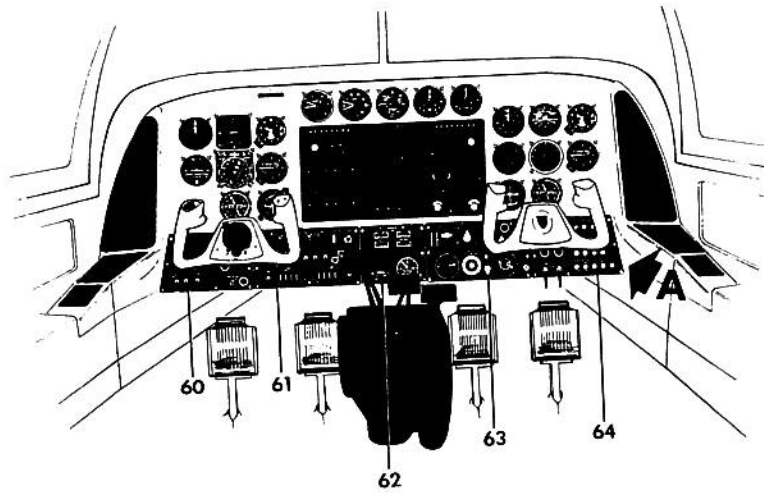

60-395-18

B E E C H C R A F T  
DUKE B60  
I L L U S T R A T E D P A R T S C A T A L O G

GAMA/ATA CODE & INDEX NO.	PART NO.	DESCRIPTION							UNITS PER ASSY	USABLE ON CODE
		1	2	3	4	5	6	7		
10-40 - 58	60-324023-3	SUPPORT,SUBPANEL STRUCTURE LH	.	.	.	.	.	.	1	
	60-324023-4	SUPPORT,SUBPANEL STRUCTURE RH	.	.	.	.	.	.	1	
	NAS220-8	SCREW	.	.	.	.	.	.	6	
	AN960D8L	WASHER	.	.	.	.	.	.	6	
	MS21042L08	NUT	.	.	.	.	.	.	6	
		*-----*								
	60-324023-13	BRACKET,FLOATING PANEL LH/SEE CHAPTER 39-10-01/	.	.	.	.	.	.	1	
	60-324023-14	BRACKET,FLOATING PANEL RH/SEE CHAPTER 39-10-01/	.	.	.	.	.	.	1	
- 59	60-324023-11	ANGLE,SUBPANEL SUPPORT LH	.	.	.	.	.	.	1	
	60-324023-7	ANGLE,SUBPANEL SUPPORT RH	.	.	.	.	.	.	1	
	R 60-324023-27	ANGLE,SUBPANEL SUPPORT RH	.	.	.	.	.	.	1	21
	K 60-324023-27	ANGLE,SUBPANEL SUPPORT RH	.	.	.	.	.	.	1	20
	112131-00606	CHAFE STRIP,SUBPANEL SUPPORT ANGLE/RH ONLY/	.	.	.	.	.	.	1	
	NAS697A06L	NUTPLATE	.	.	.	.	.	.	9	
- 60	60-324143	EDGE LIGHTED PANEL/LH OUTBD SUBPANEL	.	.	.	.	.	.	1	6
	60-324143-1	PANEL,EDGE LIGHTED/LH OUTBD SUBPANEL/	.	.	.	.	.	.	1	7
	60-324138-7	PLUG,EDGE LIGHTED PANEL HOLE	.	.	.	.	.	.	AR	
	118665	KNOB,LANDING GEAR SWITCH	.	.	.	.	.	.	1	
	AN565DBH2	SET SCREW	.	.	.	.	.	.	1	
		*-----*								
	35-380053-19	SWITCH,NAVIGATION & STROBE LIGHT	.	.	.	.	.	.	1	
	AN936A6	WASHER,FUEL QUANTITY INDICATOR	.	.	.	.	.	.	4	
- 61	60-324142	PANEL,EDGE LIGHTED/LH INBD SUBPANEL/	.	.	.	.	.	.	1	10
- 62	60-324142-3	PANEL,EDGE LIGHTED/LH INBD SUBPANEL/	.	.	.	.	.	.	1	11
	60-324141-3	PANEL,EDGE LIGHTED/CENTER SUBPANEL/	.	.	.	.	.	.	1	
	60-324144-1	PLUG,EDGE LIGHTED PANEL HOLE	.	.	.	.	.	.	AR	
	60-324144-3	PLUG,EDGE LIGHTED PANEL HOLE	.	.	.	.	.	.	AR	
	118664	LEVER,FLAP SWITCH	.	.	.	.	.	.	1	
	60-324082-1	KNOB,CABIN TEMPERATURE	.	.	.	.	.	.	1	
	60-324082	KNOB,CABIN TEMPERATURE MODE	.	.	.	.	.	.	1	
- 63	60-324140-9	PANEL,EDGE LIGHTED/RH INBD SUBPANEL/	.	.	.	.	.	.	1	1
		/USE/W MOTORIZED PRESSURIZATION CONTROL/	.	.	.	.	.	.	1	
	60-324140-7	PANEL,EDGE LIGHTED/RH INBD SUBPANEL/	.	.	.	.	.	.	1	
		/USED WITH MANUAL PRESSURIZATION CONTROL/	.	.	.	.	.	.	1	
- 64	60-324163-1	PANEL,EDGE LIGHTED/RH INBD SUBPANEL/	.	.	.	.	.	.	1	2
	60-324139-9	PANEL,EDGE LIGHTED/RH OUTBOARD SUBPANEL/	.	.	.	.	.	.	1	
	60-324138-5	PLUG,EDGE LIGHTED PANEL HOLE	.	.	.	.	.	.	AR	

BEECHCRAFT  
DUKE B60  
ILLUSTRATED PARTS CATALOG

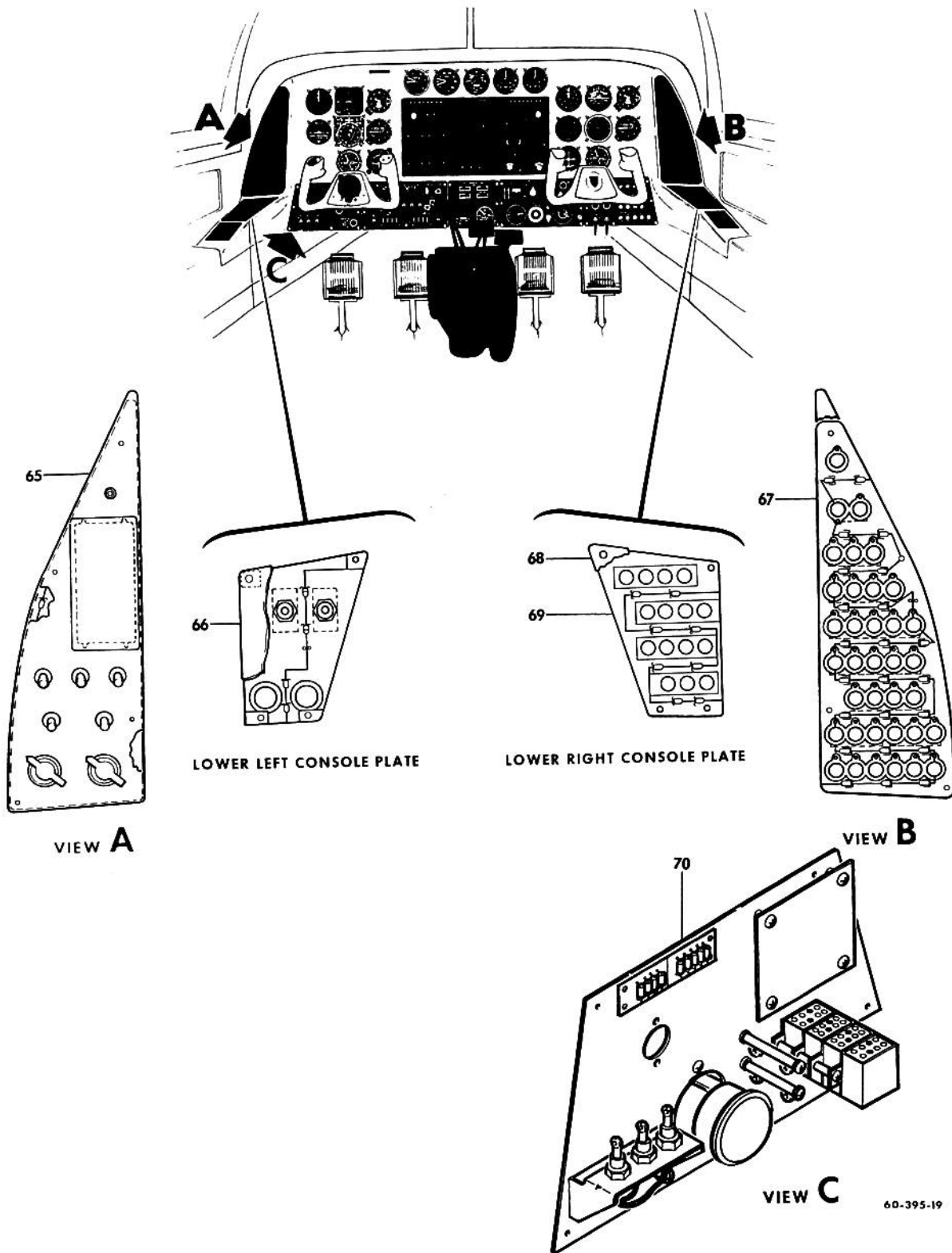



BEECHCRAFT  
DUKE B60  
ILLUSTRATED PARTS CATALOG

GAMA/ATA CODE & INDEX NO.	PART NO.	DESCRIPTION							UNITS PER ASSY	USABLE ON CODE
		1	2	3	4	5	6	7		
10-40 - 65	60-324126-1	PANEL,EDGE LIGHTED/LEFT UPPER CONSOLE/ . . . . .							1	
	AN515B6R8	/ATTACHING PARTS/ SCREW . . . . .							4	
- 66	60-324138-7	PLUG,EDGE LIGHTED PANEL HOLE. . . . .							AR	
	R 60-324129-5	PANEL,EDGE LIGHTED/LEFT LOWER CONSOLE/ . . . . .							1	25
	R 60-324129-7	PANEL,EDGE LIGHTED/LEFT LOWER CONSOLE/ . . . . .							1	26
	R 60-324129-9	PANEL,EDGE LIGHTED/LEFT LOWER CONSOLE/ . . . . .							1	24
	AN515B6R8	/ATTACHING PARTS/ SCREW . . . . .							4	
- 67	60-324144-5	PLUG,EDGE LIGHTED PANEL HOLE. . . . .							AR	
	60-324132-3	PANEL,EDGE LIGHTED/RIGHT UPPER CONSOLE/ . . . . .							1	8
	60-324132-7	PANEL,EDGE LIGHTED/RIGHT UPPER CONSOLE. . . . .							1	9
	60-324132-9	PANEL,EDGE LIGHTED/RIGHT UPPER CONSOLE/ . . . . .							1	12
	60-324132-13	PANEL,EDGE LIGHTED/RIGHT UPPER CONSOLE/ . . . . .							1	13
	MS35214-27 130290-4	/ATTACHING PARTS/ SCREW . . . . . NUT,SELF-LOCKING CLIP . . . . .							4 4	
- 68	60-324138-1	PLUG,EDGE LIGHTED PANEL . . . . .							AR	
	60-324135	PANEL EDGE LIGHTED/RH LOWER CONSOLE/. . . . .							1	
- 69	60-324133-3	PRINTED CIRCUIT BOARD ASSY. . . . .							1	
	AN515B6R8	/ATTACHING PARTS/ SCREW . . . . .							4	
- 70	60-3640000-1	PANEL,ELECTRICAL EQUIPMENT MOUNTING LH. . . . .							1	18
	60-364000-111	PANEL,ELECTRICAL EQUIPMENT MOUNTING LH. . . . .							1	17
	60-3640000-3	PANEL,ELECTRICAL EQUIPMENT MOUNTING RH. . . . .							1	

CODES OF EFFECTIVITY

1 P-247 THRU P-307	2 P-308 AND AFTER
3 P-247 THRU P-315	4 P-316 THRU P-555
5 P-247 THRU P-284	6 P-247 THRU P-266
7 P-267 AND AFTER	8 P-247 THRU P-347, P-349 THRU P-364
9 P-348,P-365 THRU P-385,P-387 THRU P-400	10 P-247 THRU P-385,P-387 THRU P-400
11 P-386, P-401 AND AFTER	12 P-386,P-401 THRU P-445
13 P-446 AND AFTER	14 P-348,P-365 THRU P-385, P-387 AND AFTER
15 P-247 THRU P-445	16 P-446 THRU P-555
17 P-556 AND AFTER	18 P-247 THRU P-555
19 P-247 THRU P-519	20 P-579 AND AFTER
21 P-247 THRU P-578	22 P-247 THRU P-575
23 P-576 AND AFTER	24 P-572 AND AFTER
25 P-247 THRU P-426 P-430 P-434 THRU P-465	26 P-427 THRU P-429 P-431 THRU P-433 P-466 THRU P-571



BEECHCRAFT  
DUKE B60  
ILLUSTRATED PARTS CATALOG

39-15-01  
INDEPENDENT INSTRUMENTS /CABIN/

BEECHCRAFT  
DUKE B60  
ILLUSTRATED PARTS CATALOG

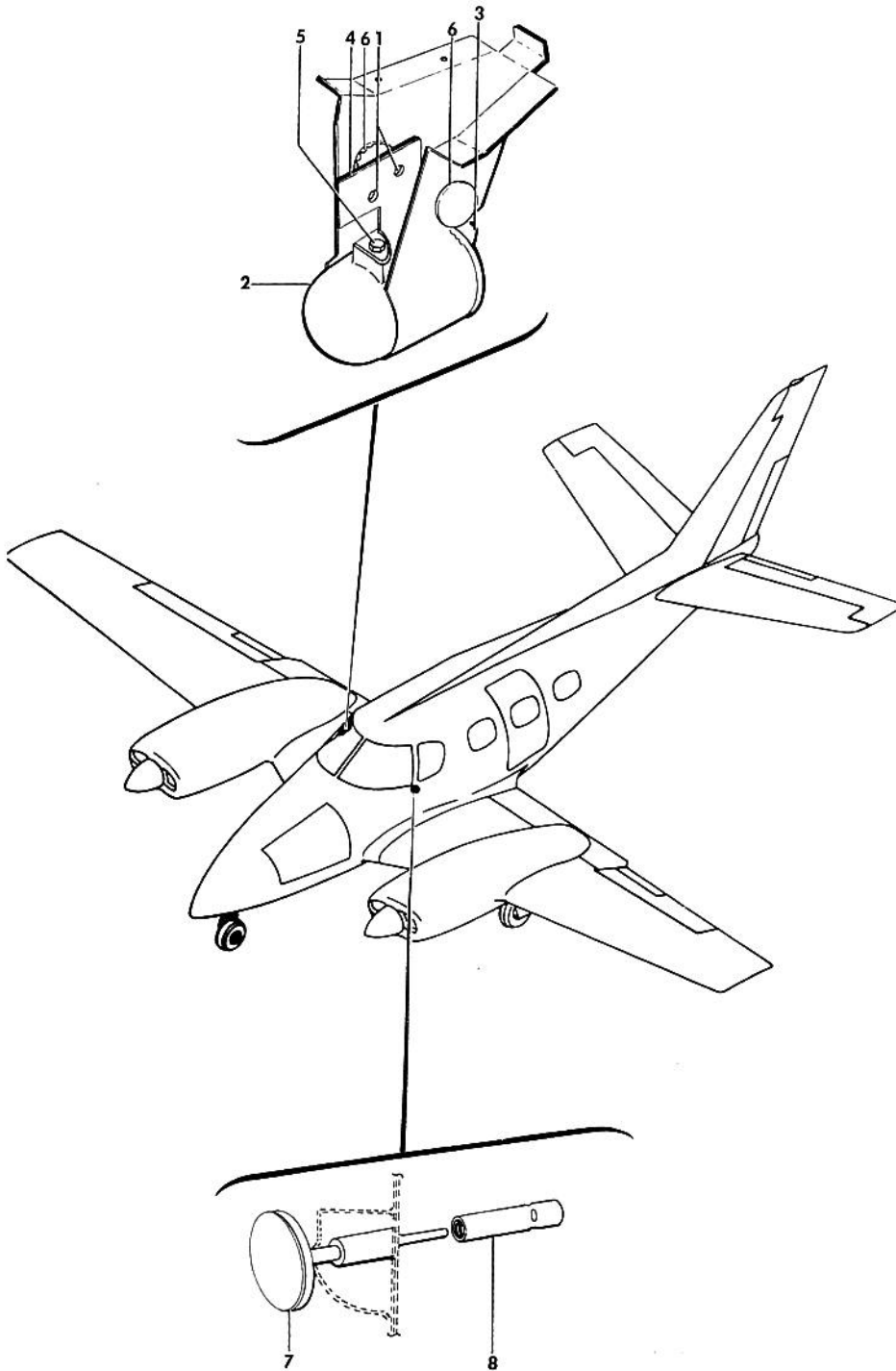

B60-390-6

B E E C H C R A F T  
DUKE 860  
I L L U S T R A T E D P A R T S C A T A L O G

GAMA/ATA CODE & INDEX NO.	PART NO.	DESCRIPTION							UNITS PER ASSY	USABLE ON CODE
		1	2	3	4	5	6	7		
15-01	60-324146-1	COMPASS INSTL,MAGNETIC. . . . .							NP	
	60-324146-5	. COMPASS ASSY,MAGNETIC . . . . .							1	
		/ATTACHING PARTS/								
- 1	AN520B10R8	. SCREW . . . . .							2	
	MS20365B1032	. NUT . . . . .							2	
		*-----*								
- 2	C2400L4VT95B	. . COMPASS,MAGNETIC /BLUE-WHITE LIGHT/ . . . . .							1	
	C2400L4VT95	. . COMPASS,MAGNETIC/OPTIONAL RED LIGHT/. . . . .							1	
		/ALTERNATE FOR C2400L4JM24/								
	C2400L4JM24	. . COMPASS,MAGNETIC/OPTIONAL RED LIGHT/. . . . .							1	
		/ALTERNATE FOR C2400L4VT95/								
- 3	C24-550B	. . . LIGHT ASSY,BLUE-WHITE . . . . .							1	
	C24-550	. . . LIGHT ASSY,RED/OPTIONAL/. . . . .							1	
	327	. . . BULB,LIGHT. . . . .							1	
- 4	60-324146-11	. . BRACKET,COMPASS MOUNTING. . . . .							1	
		/ATTACHING PARTS/								
- 5	AN515B4R8	. . SCREW . . . . .							3	
	MS20365B440	. . NUT . . . . .							3	
		*-----*								
- 6	NAS451-52	. PLUG,BUTTON . . . . .							2	
	60-324051	INDICATOR INSTL,FREE AIR TEMPERATURE. . . . .							NP	
- 7	50-384077-5	. INDICATOR,FREE AIR TEMPERATURE. . . . .							1	
	AN316-5R	. NUT,INDICATOR . . . . .							1	
- 8	60-324052-5	. FIXTURE,CONTROL HOLDING . . . . .							1	
	R 35-380138-3	METER,FLIGHT HOUR . . . . .							1	1
	R 35-380138-5	HOURMETER,DIGITAL/FLIGHT & ENGINE/. . . . .							2	2

CODES OF EFFECTIVITY

1 P-247 THRU P-571      2 P-572 AND AFTER

